

Window and Door

PRODUCT PRESENTATION

BOLD AND BRILLIANT
WINDOWS AND DOORS



TM 102
PASSIVE



TM 77
PANO



TM 62
SCENIC



PRESTIGE
DOOR

THERMAL INSULATED SYSTEM

THE SYSTEMS

TM102/ Passive



TM77/ Pano



TM62/ Scenic



- Excellent Solar Heat Gain Coefficient (SHGC) from 0.18 to 0.55
- Possibility of creating large openings:
 - Fixed units up to 100 sqf
 - Operable TT windows : 5ft Wide x 10ft High
- A wide variety of options, including all-glass corners, Juliet Balconies, insect screens, LED profiles

- Double, triple and quad glazing options
- PTAC ventilation grids
- Ability of mulling all Yawal systems

SYSTEMS IN NUMBERS

TM 102/ PASSIVE

- Glass thickness:
 - > for fixed units 35 – 69 [mm] 1,37" - 2,71"
 - > for operable sash 44 – 72 [mm] 1,73" – 2,83"
- U-Value: from **0.10 Btu/hft²F**

WINDOW:

- Air tightness: 0,002cfm/ft²
- Water tightness: 15 psf
- Designed pressure: fixed : AW PG 75 psf
DAW : CW PG 65 psf

TM77/ Pano

- Glass thickness:
 - > for fixed units 19 – 61 [mm] 0,75" - 2,40"
 - > for operable sash 28 – 67 [mm] 1,10" – 2,63"
- U-Value: from **0.12 Btu/hft²F**

WINDOW:

- Air tightness: 0,003cfm/ft²
- Water tightness: 15 psf
- Designed pressure: fixed : AW PG 75 psf
DAW : CW PG 65 psf

DOOR:

- Water tightness: 9 psf
- Designed pressure : CW PG 60 psf

TM62/ Scenic

- Glass thickness:
 - > for fixed units 6 – 45 [mm] 0,24" – 1,77"
 - > for operable sash 14 – 54 [mm] 0,55" – 2,13"
- U-Value: from **0.17 Btu/hft²F**

WINDOW:

- Air infiltration: 0,005cfm/ft²
- Water tightness: 15 psf
- Designed pressure: fixed : CW PG 75 psf
DAW : CW PG 65 psf

DOOR:

- Water tightness: 9 psf
- Designed pressure : CW PG 60 psf

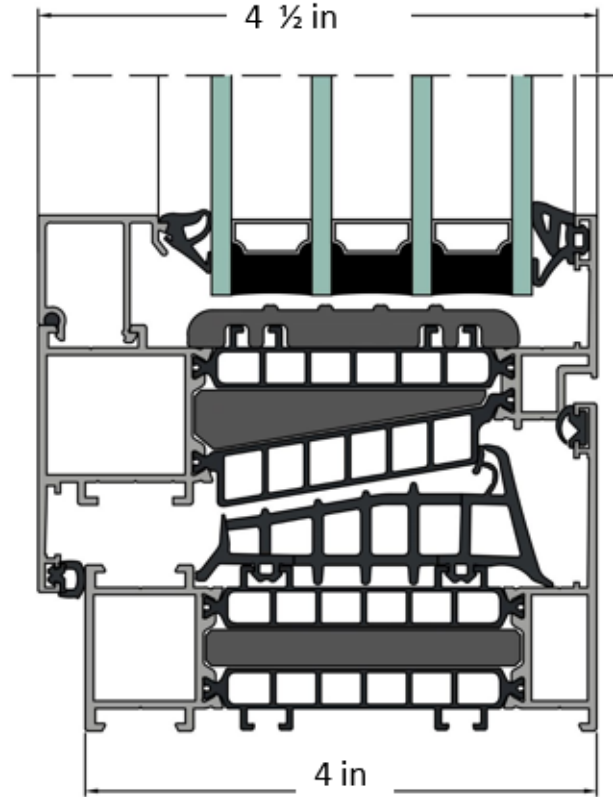

- dedicated to energy-saving and passive buildings
- possibility of changing glazing bead, reversible from interior to exterior
- excellent level of energy-saving and very high water-tightness
- possibility of combination with other Yawal systems

TM102 is the best and the most energy efficient system available from YAWAL.

TM 102 / PASSIVE



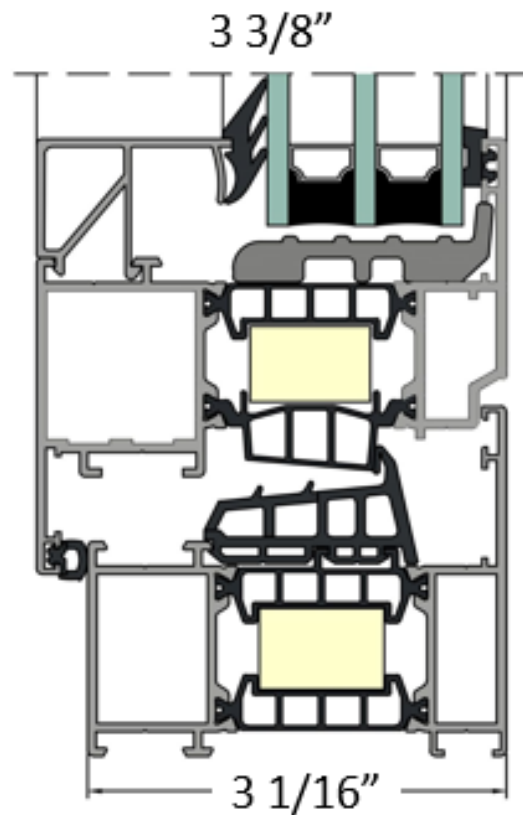

- More natural light, oversize/jumbo capabilities
- possibility of creating modern elements of various shapes and configurations
- possibility of combining/mulling with other Yawal systems

TM 77 / PANO



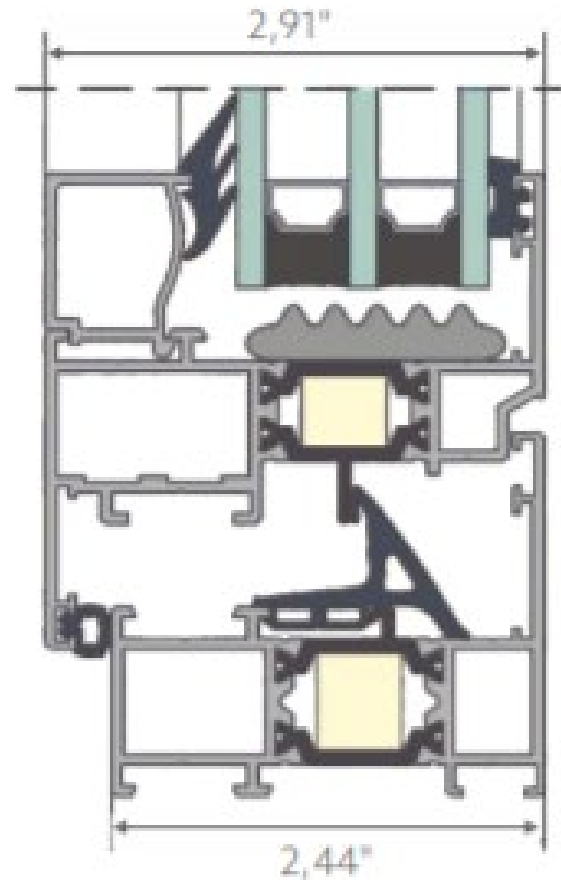

- system meets the design requirements for commercial and residential buildings
- Budget-friendly for light commercial projects
- possibility of combining/mulling with other Yawal systems

TM 62 / SCENIC



COMPARISON OF ISOTHERMS

TM102/ Passive

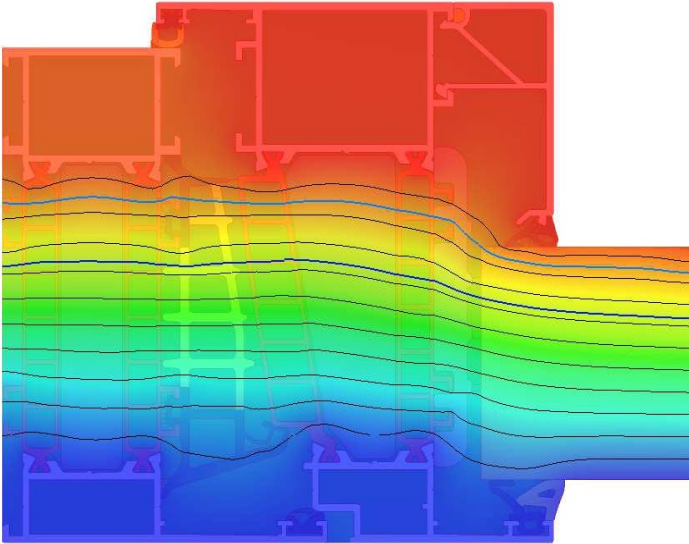

■ U-Value: **0.10 Btu/hft²F**

TM77/ Pano

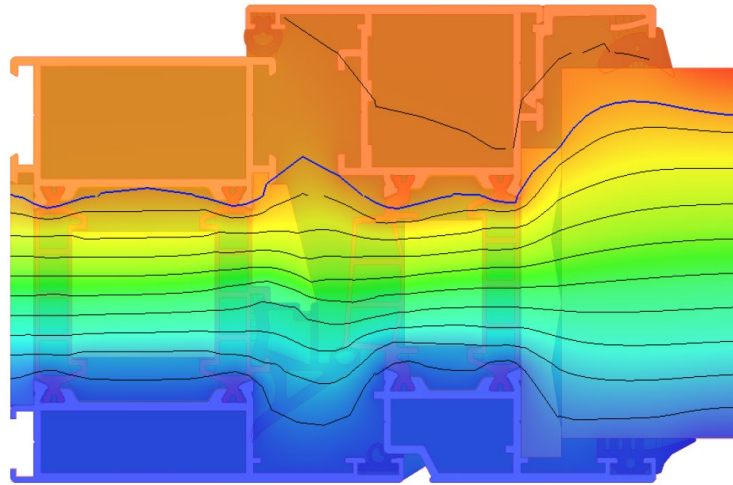

■ U-Value: **from 0.12 Btu/hft²F**

TM62/ Scenic

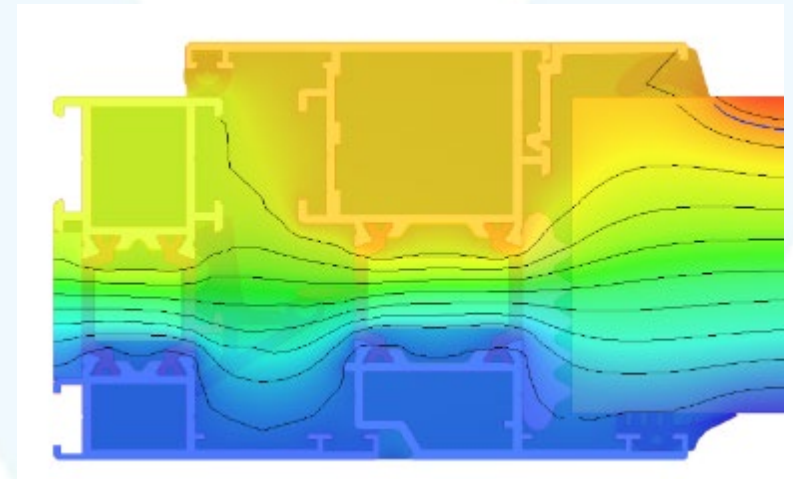

■ U-Value: **from 0.17 Btu/hft²F**

FRAME PROFILES

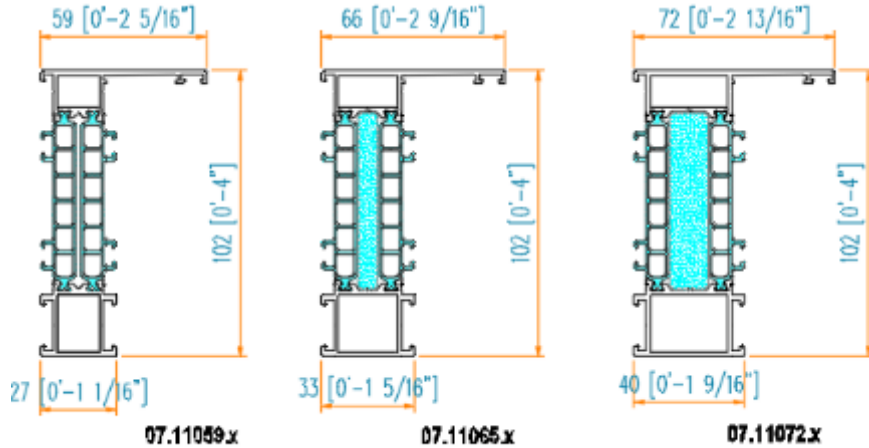

TM 102
PASSIVE

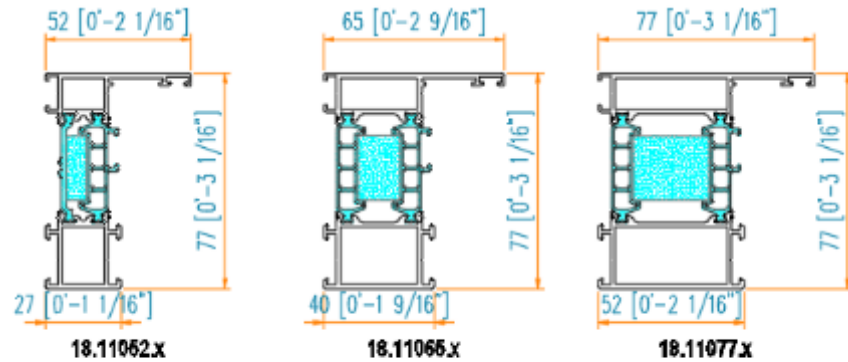

TM 77
PANO

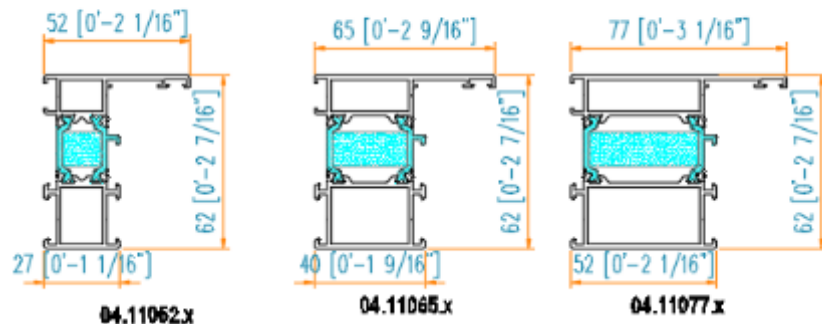

TM 62
SCENIC

SASH PROFILES

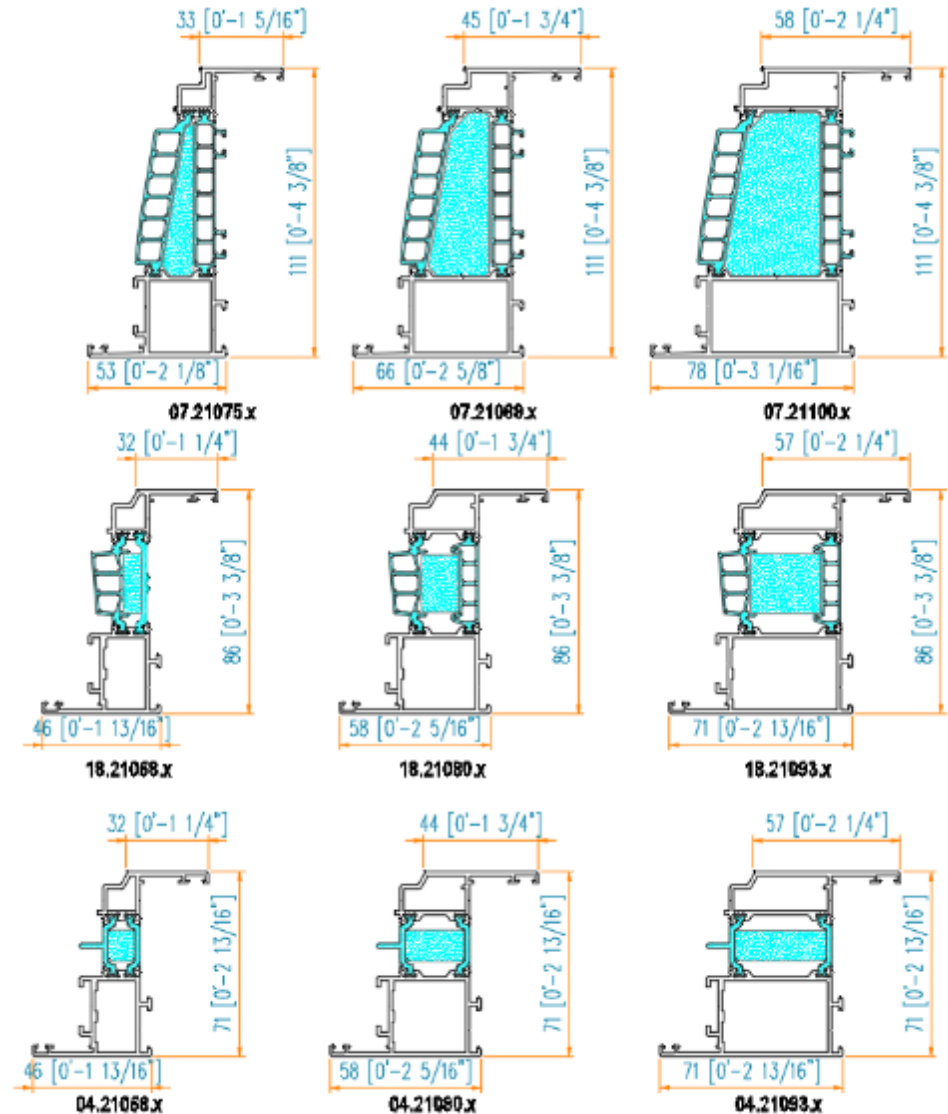

Dimensions diagrams for operable units

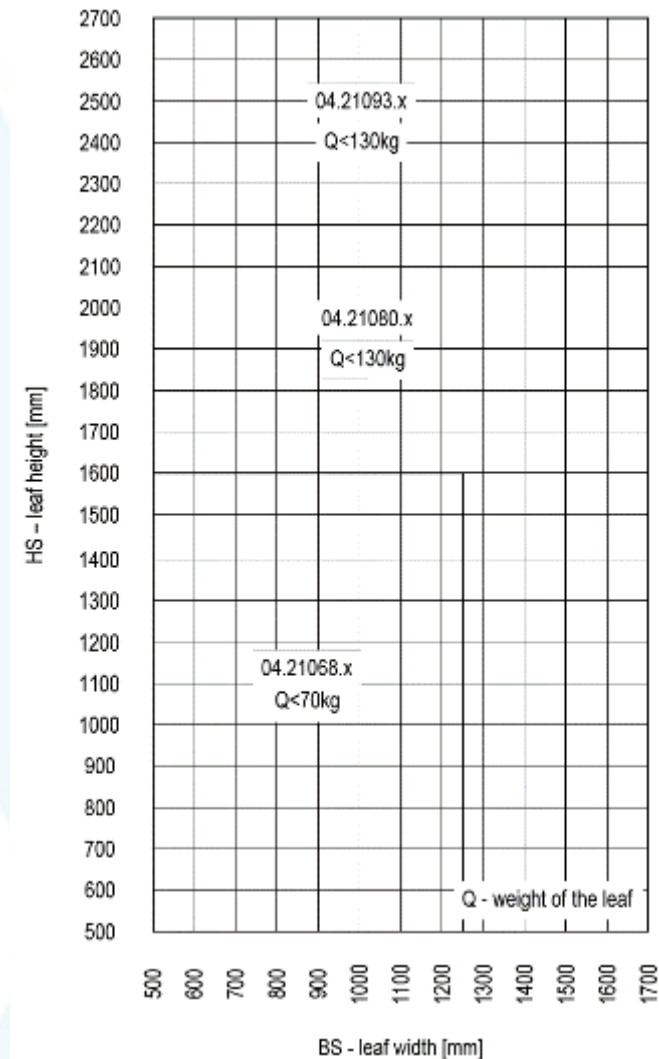
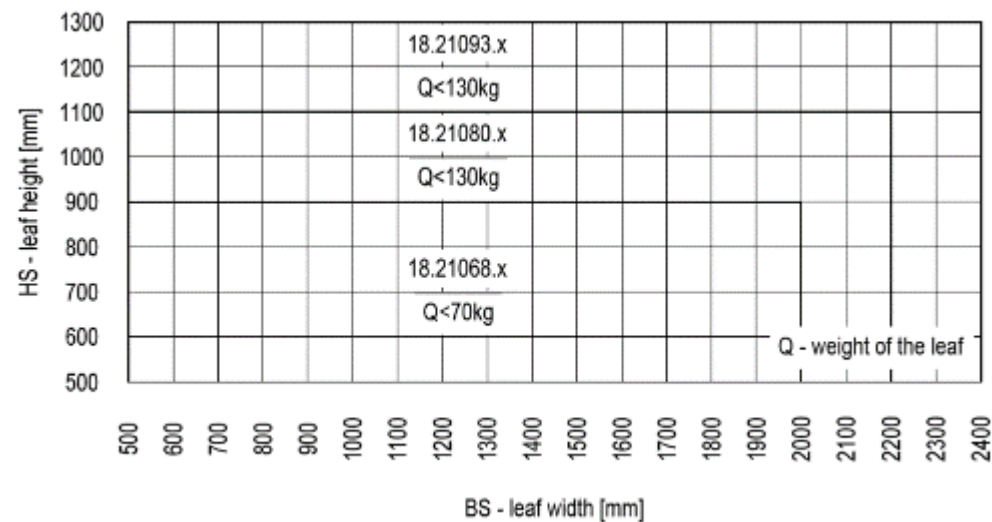
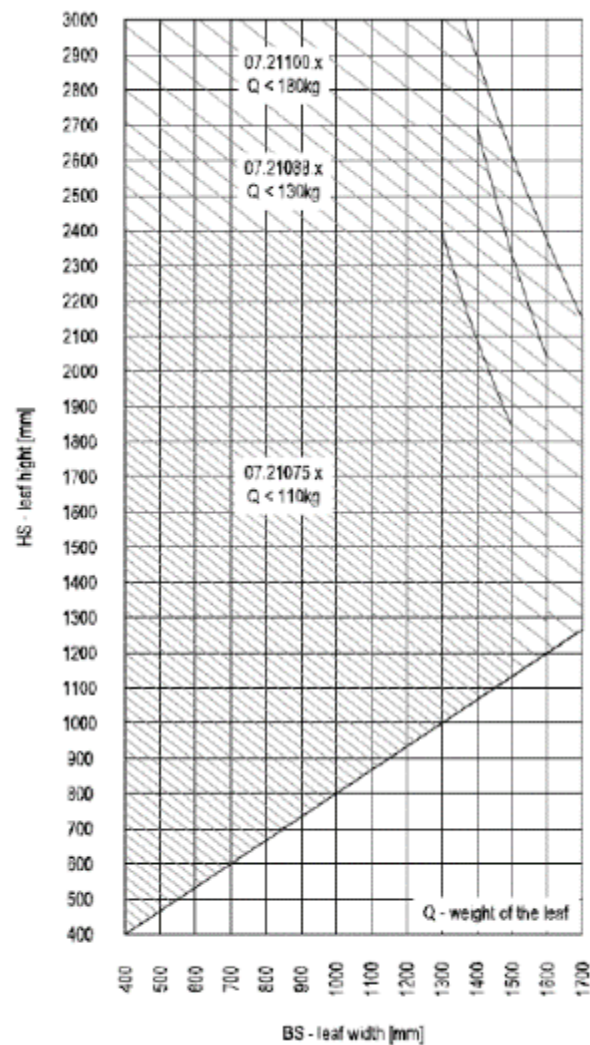

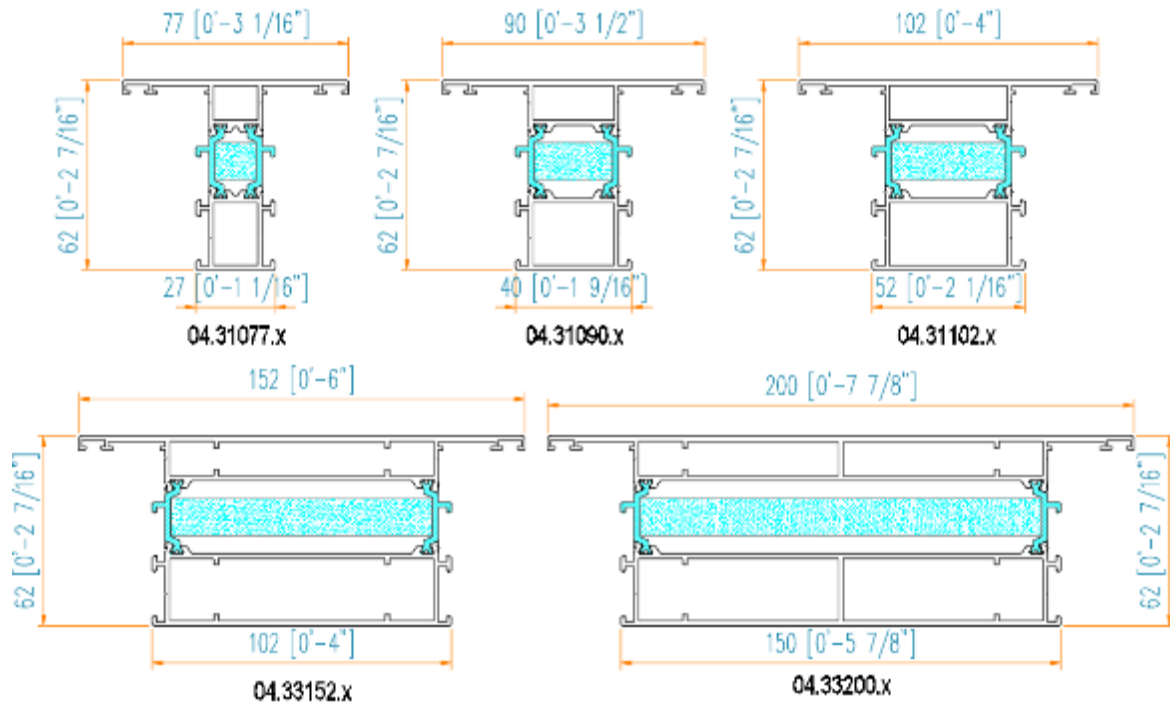

FIXED POST TM 62 / SCENIC

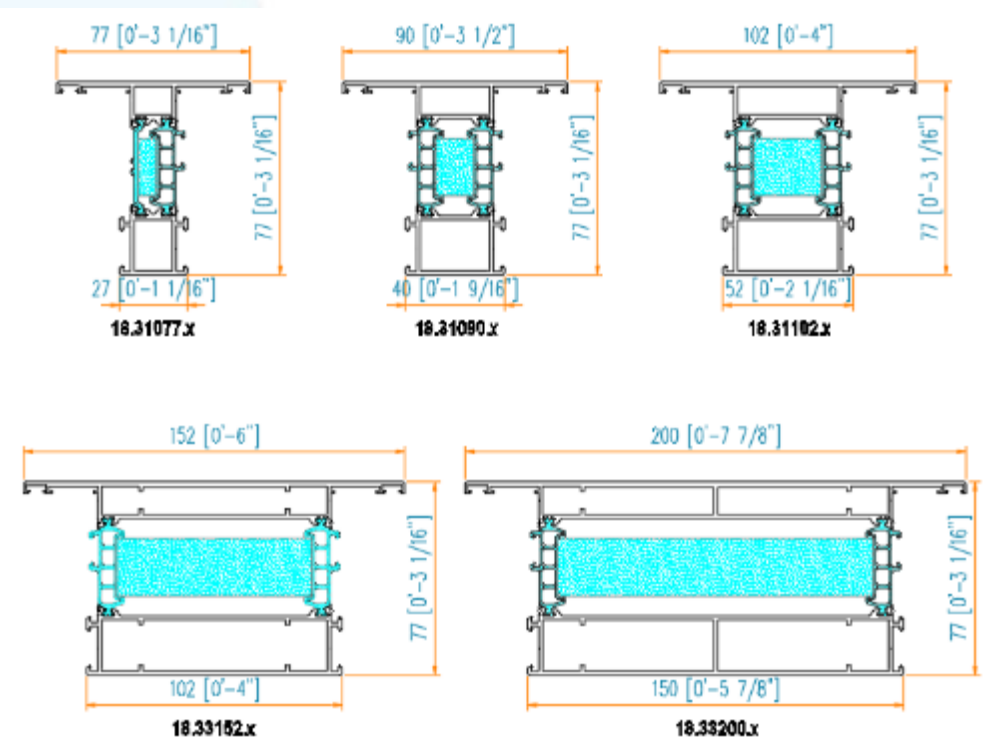

FIXED POST TM 77 / PANO

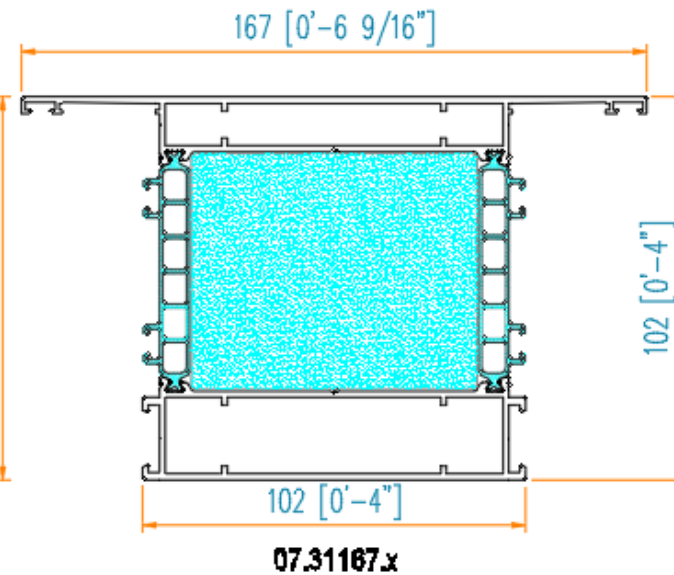
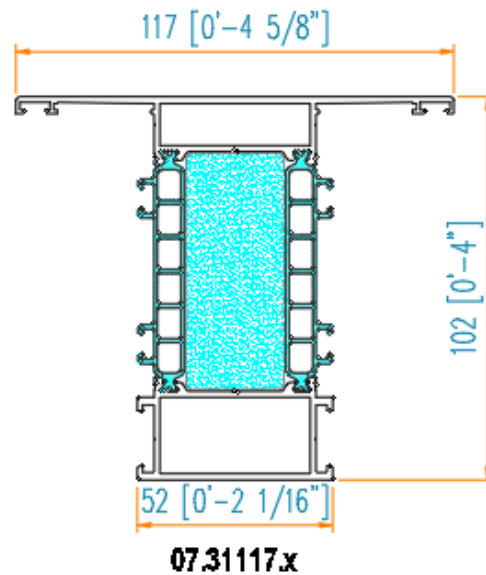
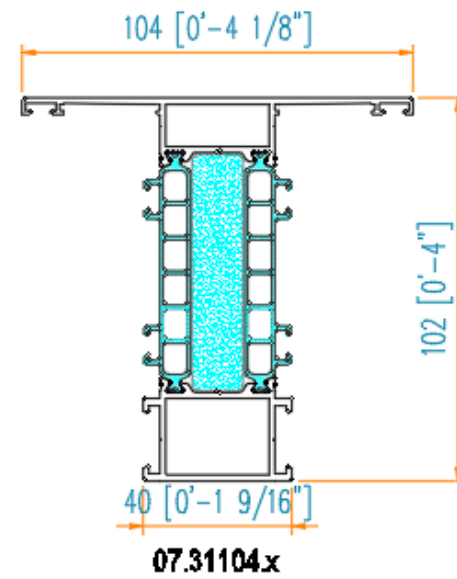
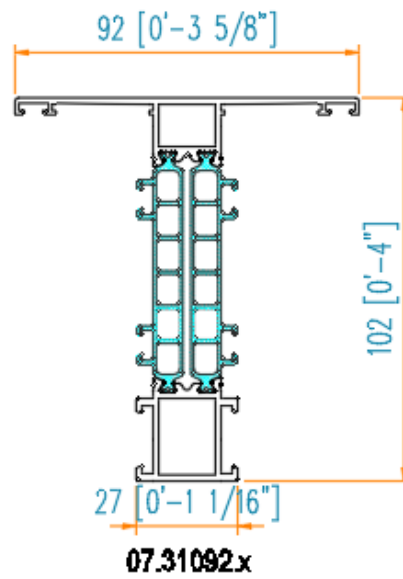

FIXED POST TM 102 / PASSIVE

REINFORCEMENT PROFILES

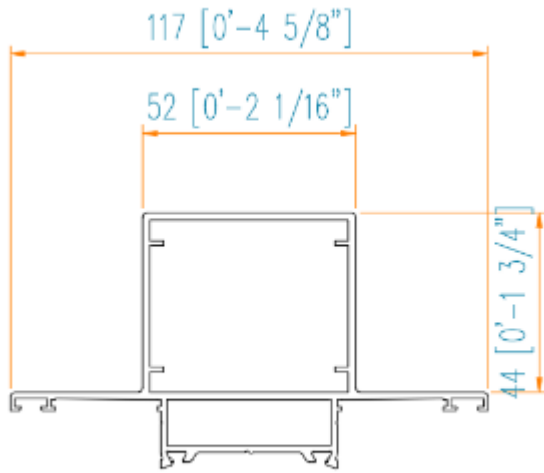

XX.31802.x

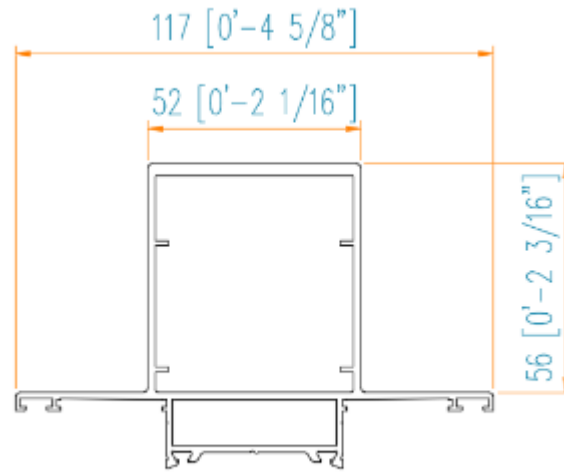

XX.31852.x

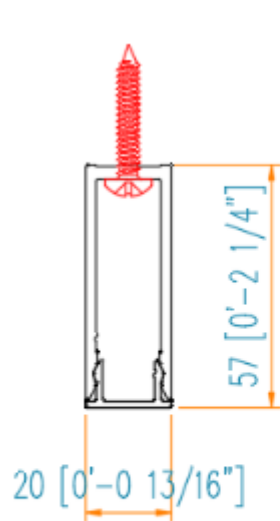

01.83020.x

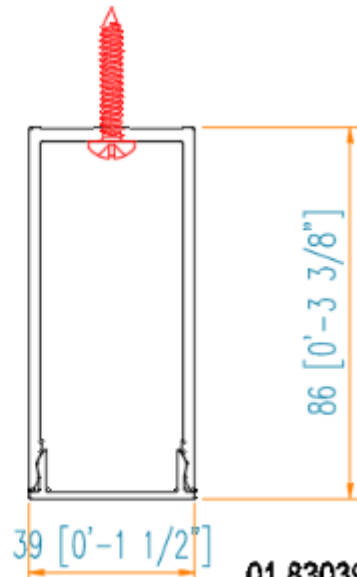

01.83039.x

EXAMPLE

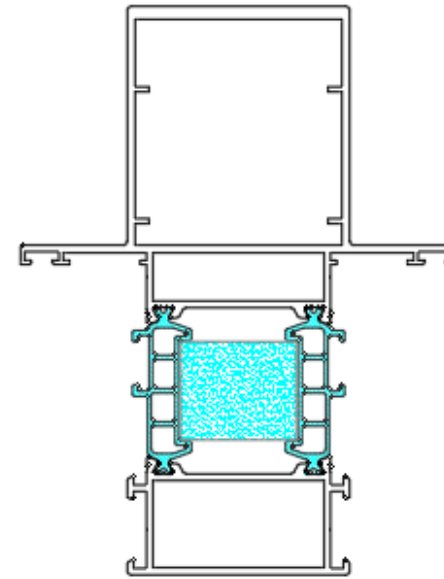

18.31852.x

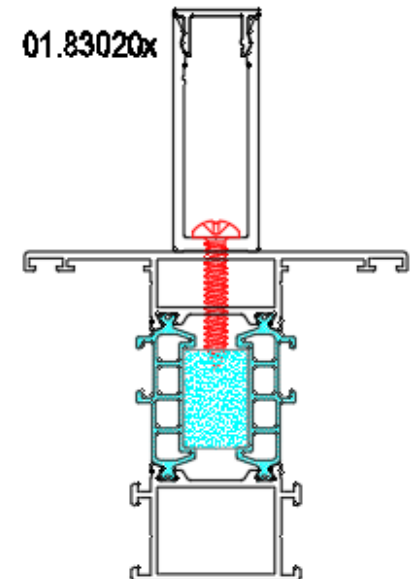

18.31090.x

Typical operation and mulling options

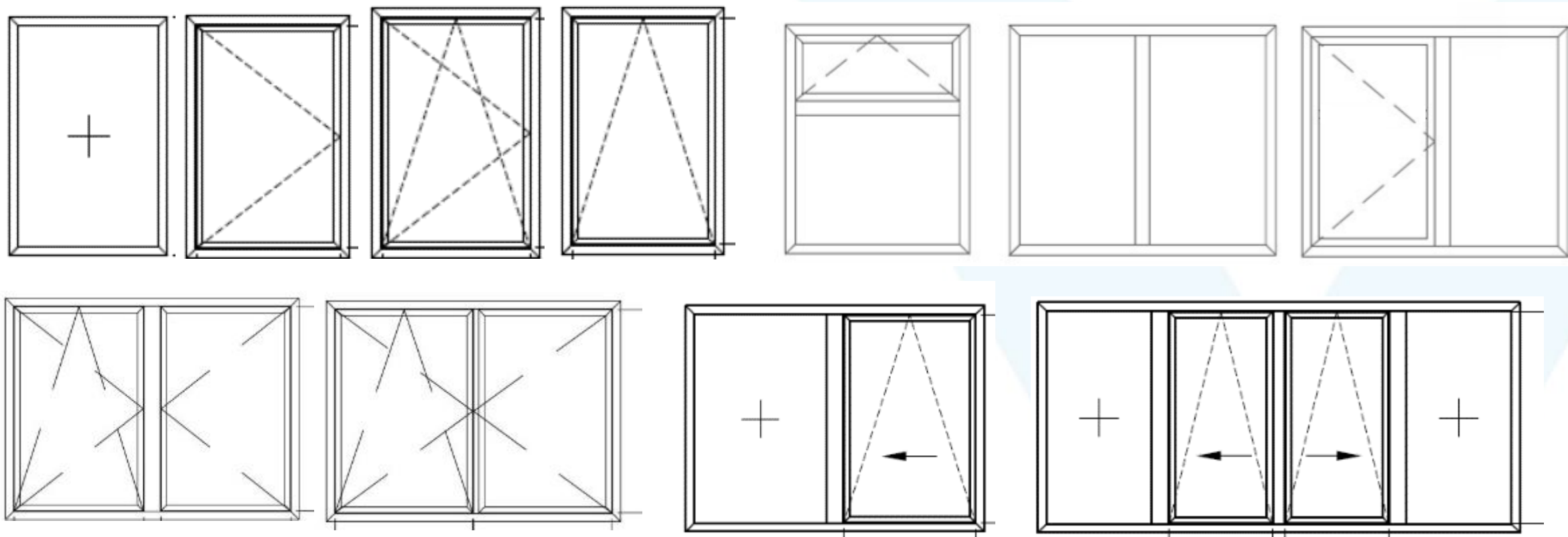

FIXED POST vs FLYING MULL

Fixed post

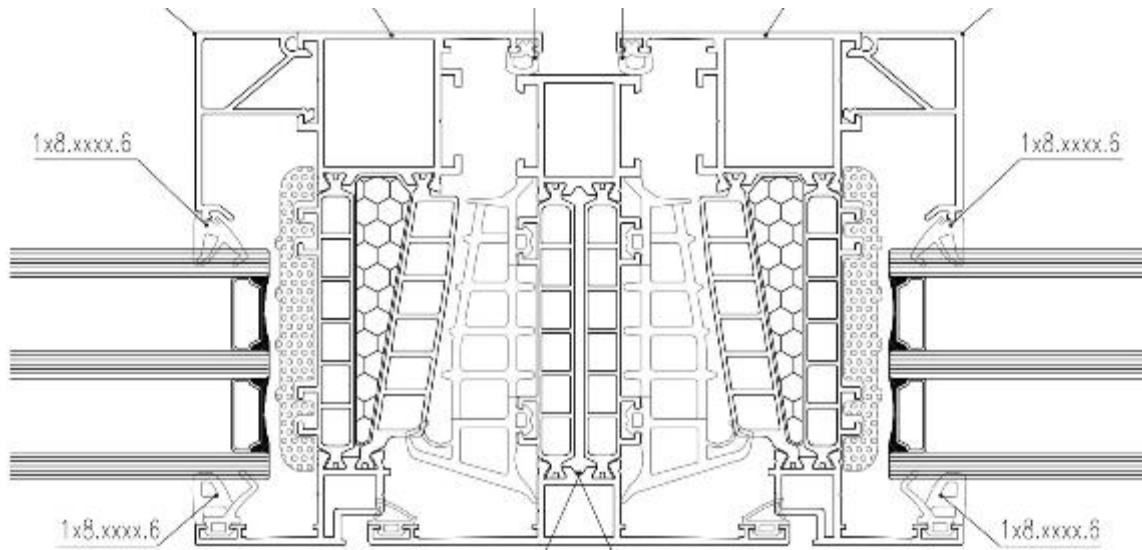
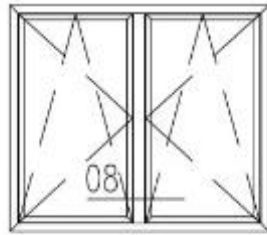

Flying post

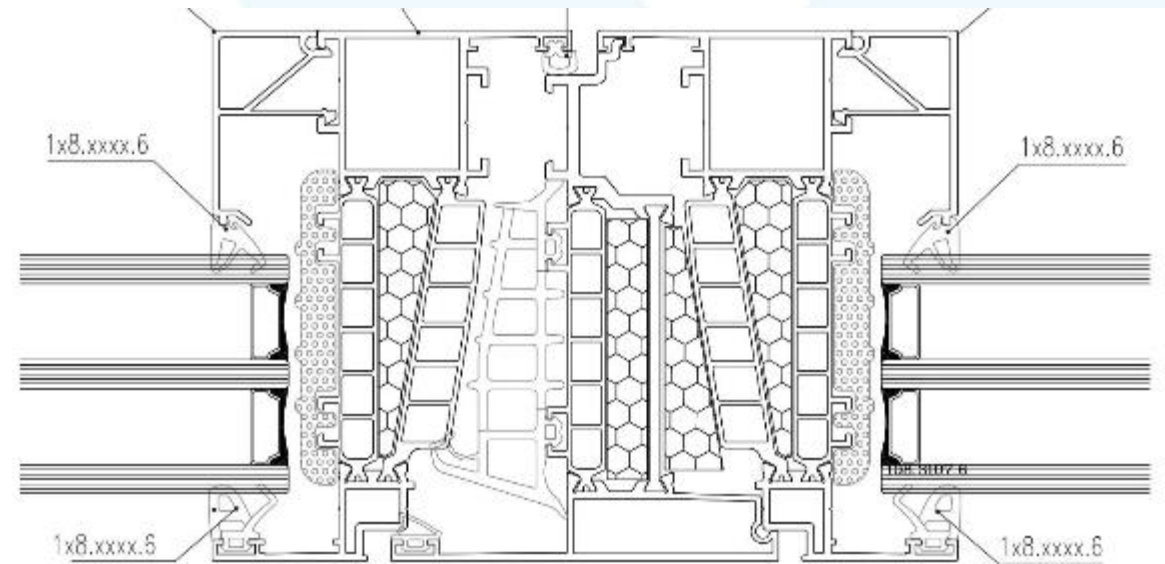
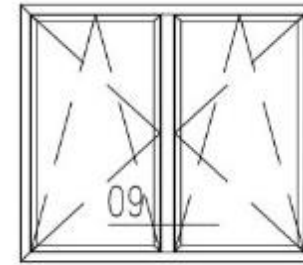

TWO FRAME CONNECTION

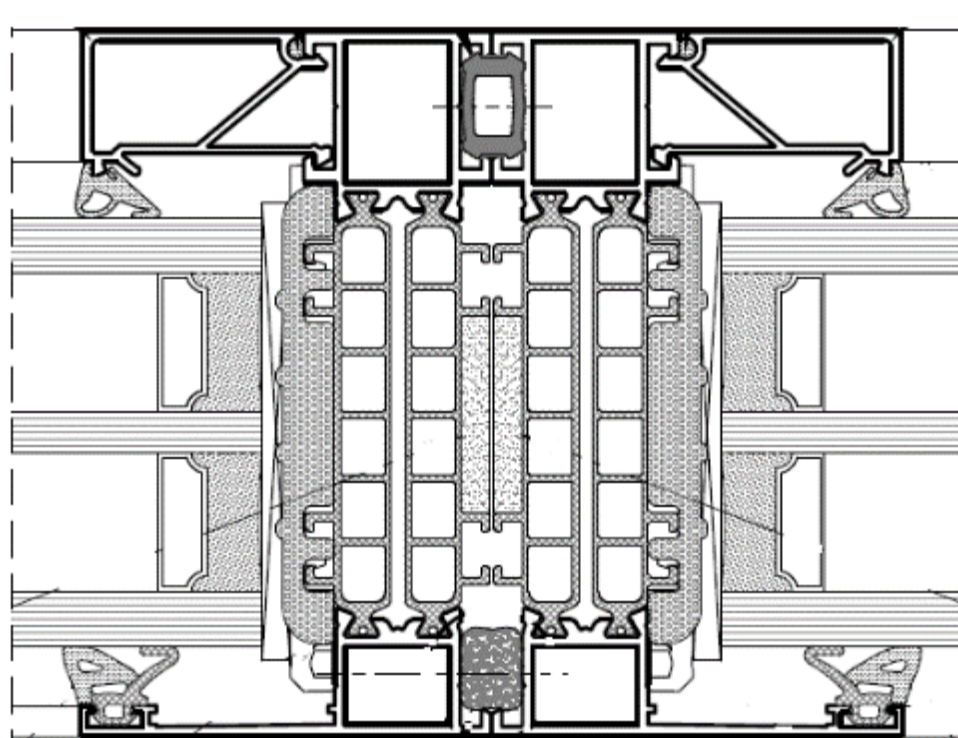
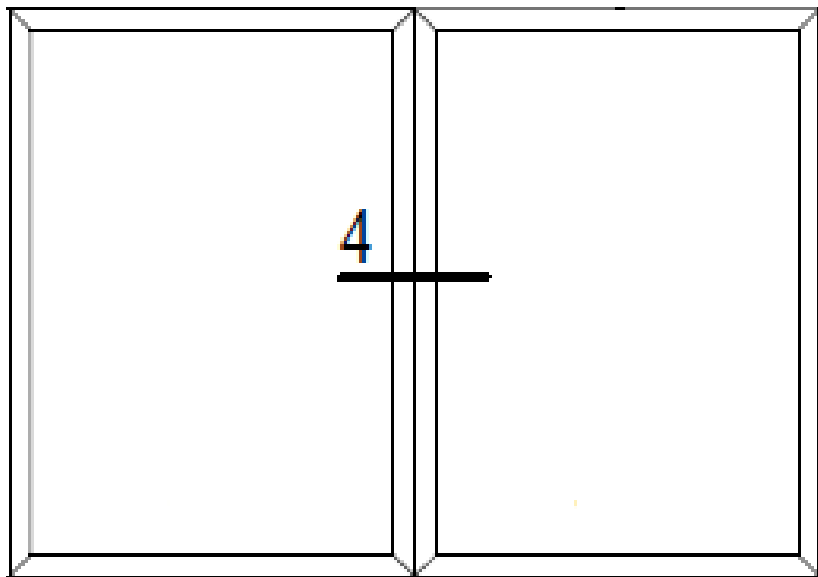

Straps installation

Available in each system

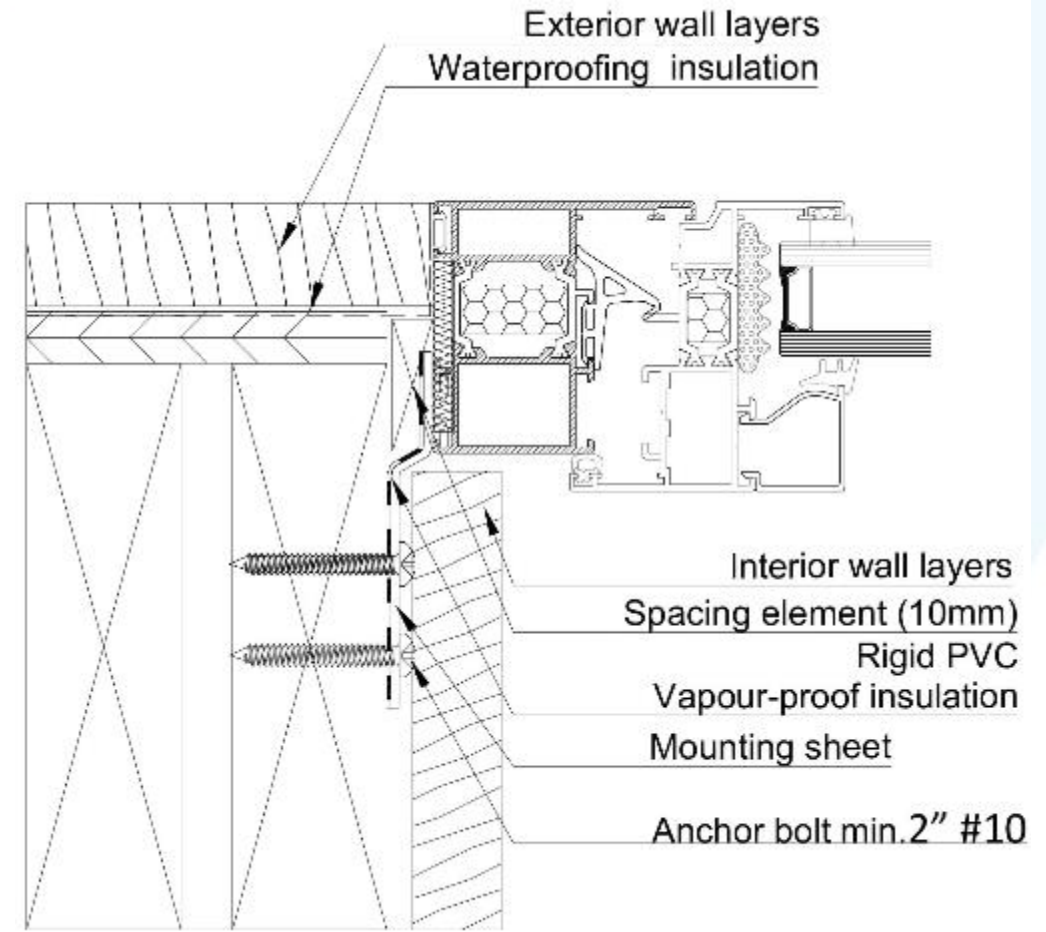
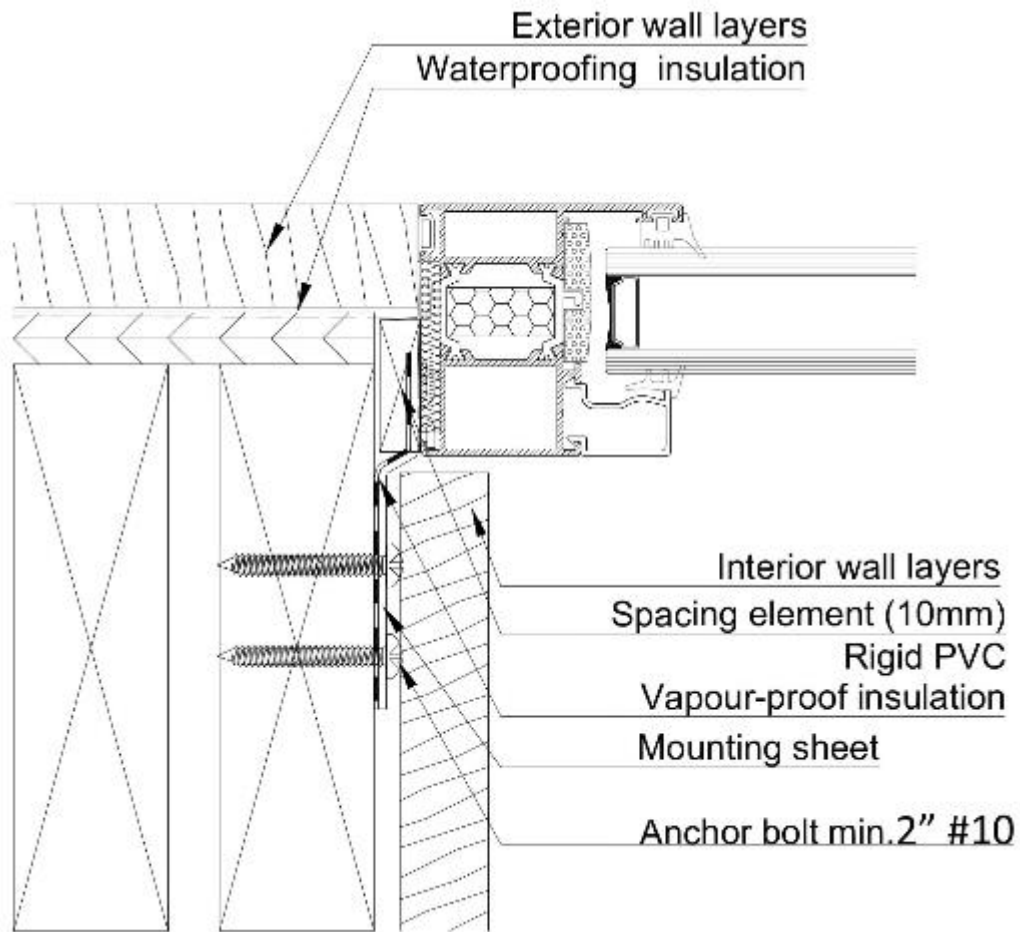

Through frame installation example

Available in each system

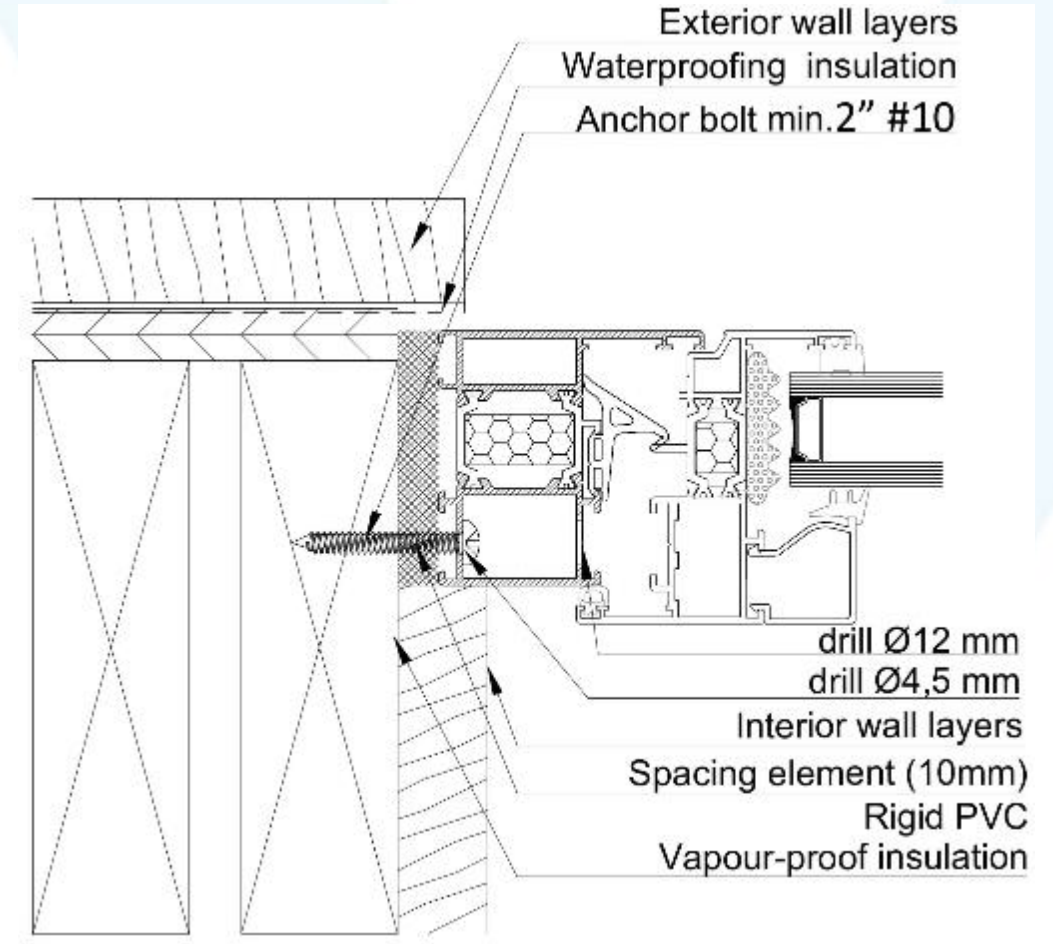
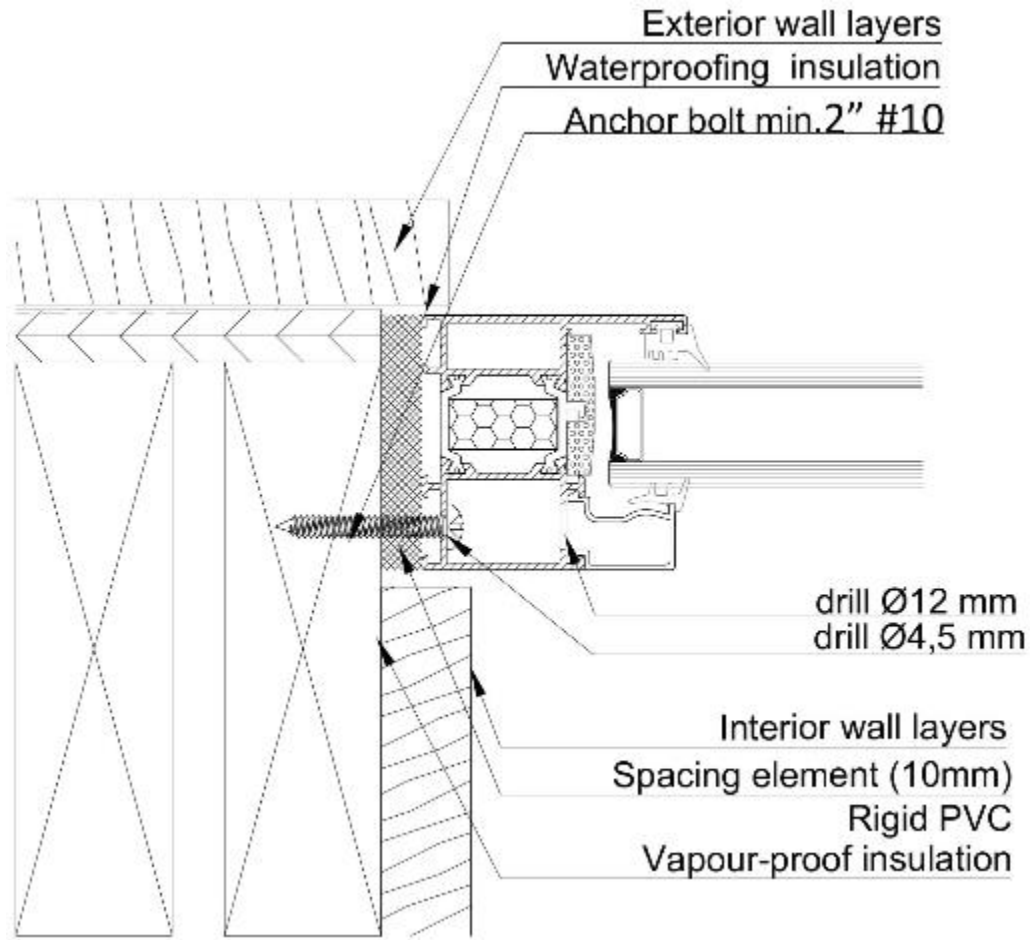

Location of installation straps

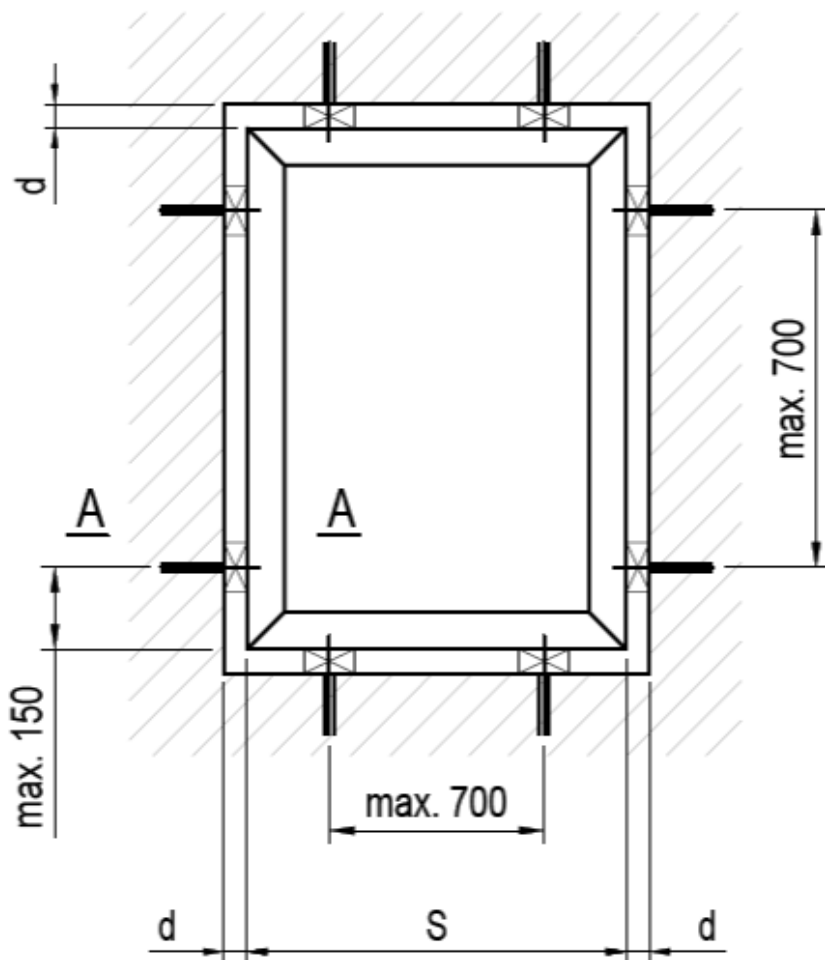

Item width to up [mm]	S	<2500	<3500	<4500
Minimum gap width [mm]	d	10	15	20

Nailfin installation example

Available only for TM77 and TM 62

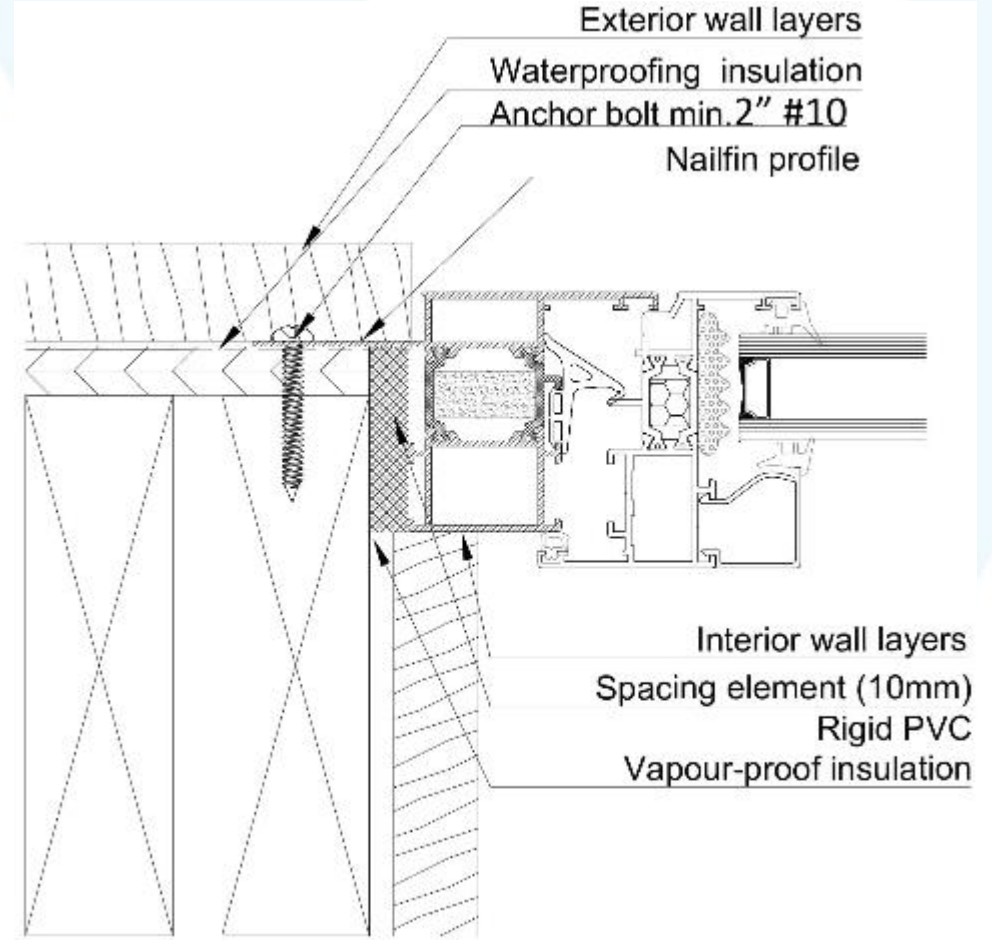
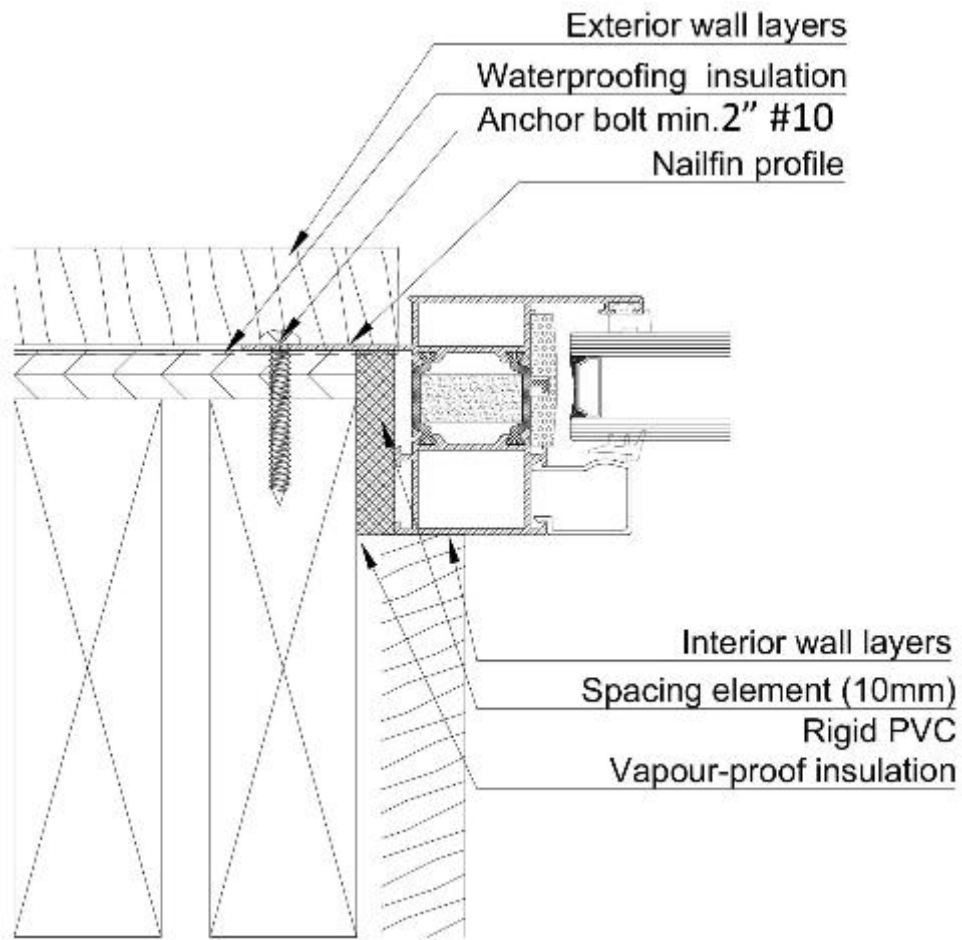

Nailfin profile

TM 77 / PANO

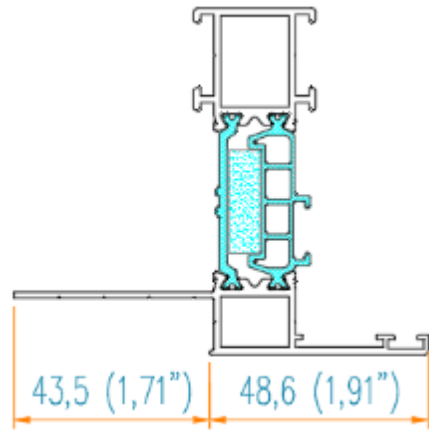

18.11152.x

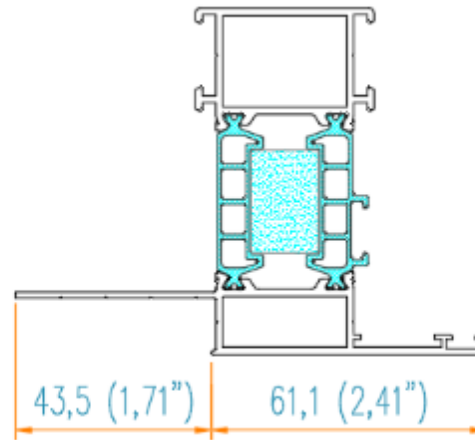

18.11165.x

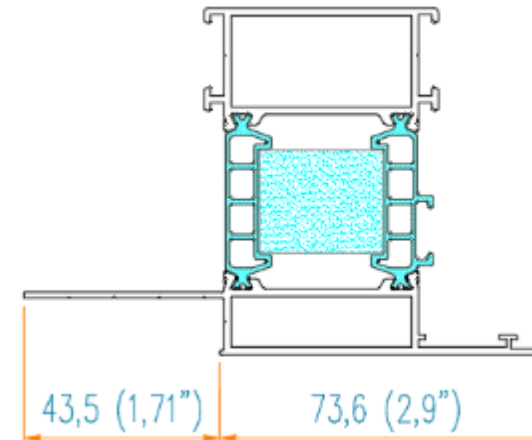

18.11177.x

TM 62 / SCENIC

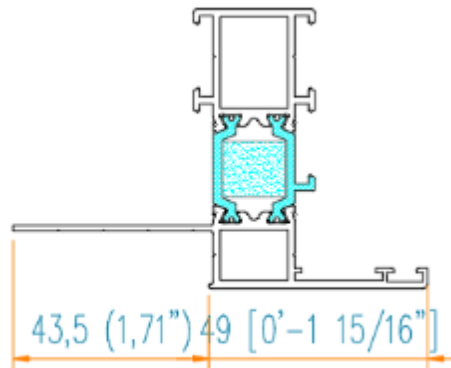

04.11152.x

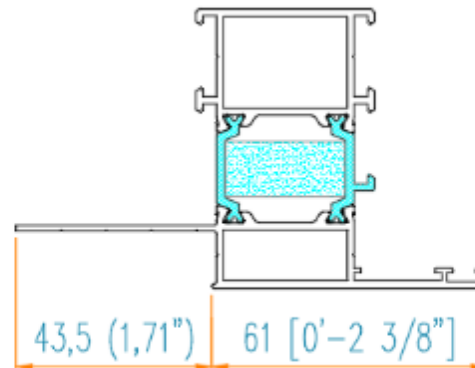

04.11165.x

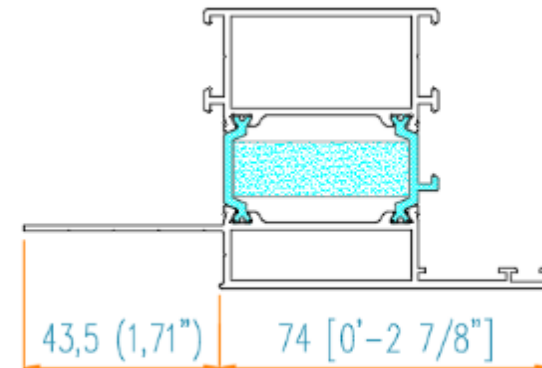

04.11177.x

Weep holes

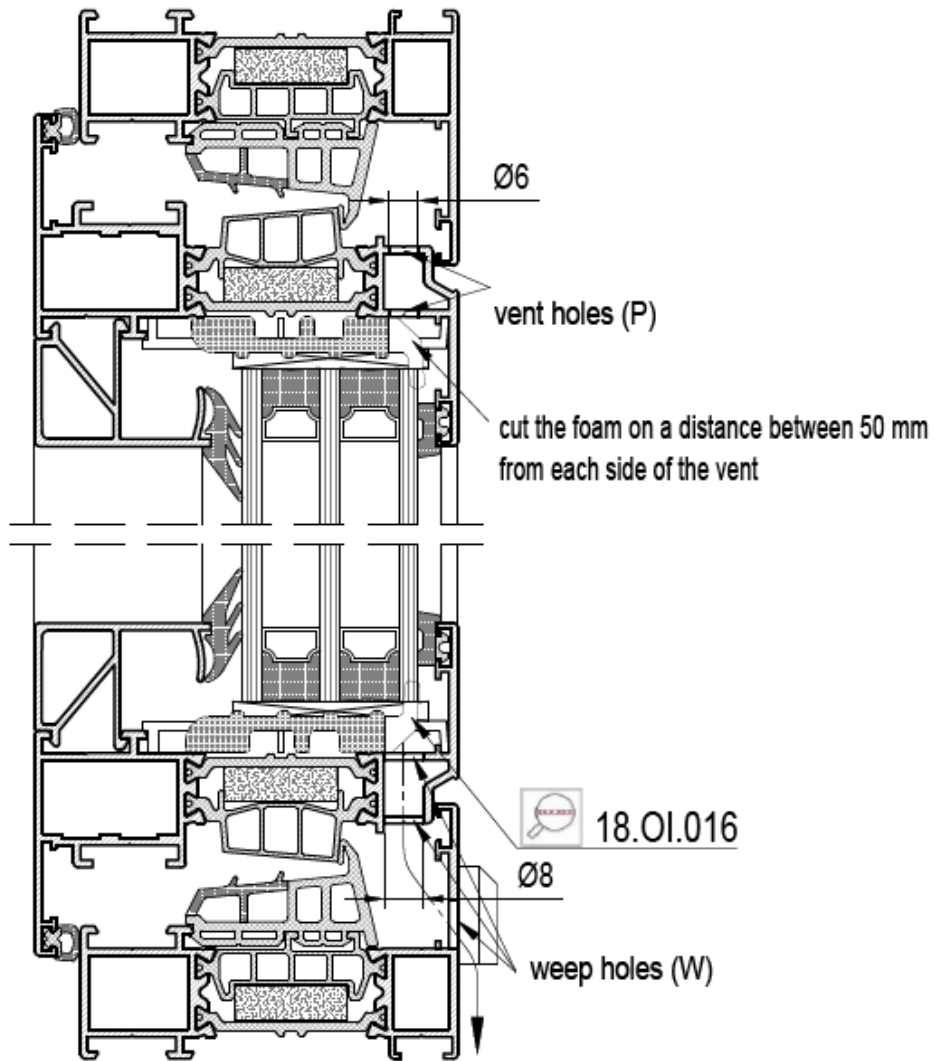

Only black color

STANDARD SOLUTION

Weep holes

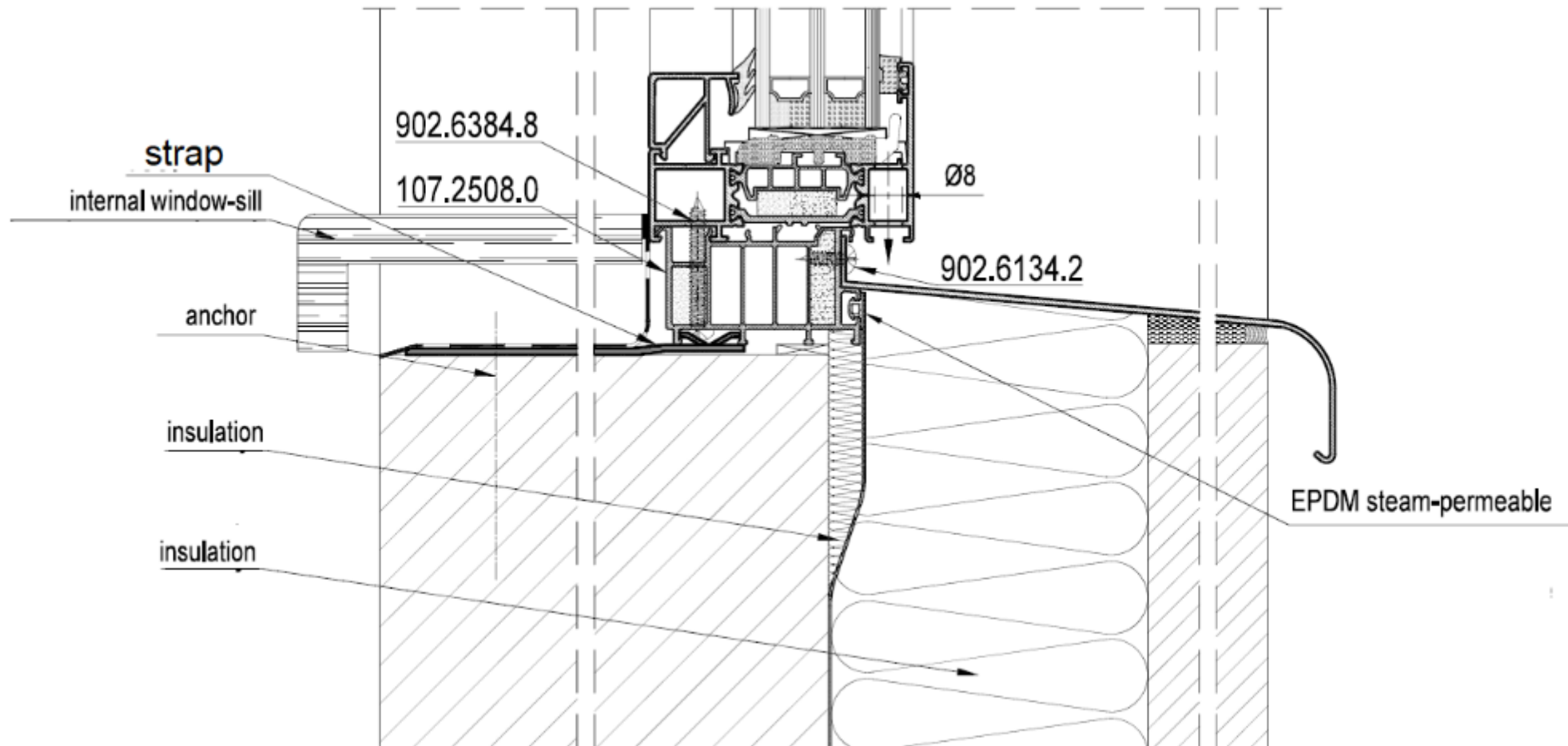

OPTION

HARDWARE

TM102/ Passive

Hidden hinges



Handle color as interior frame



TM77/ Pano & TM62/ Scenic

Visible hinges color as interior frame



STANDARD SOLUTION

HARDWARE OPTIONS

HANDLES

ROTO T300



Color: the same as frame

ROTO LINE



Color: Stainless steel

ROTO LINE with key



Color: Stainless steel

Standard with key



Color: the same as frame



INDUSTRIAL



HIDDEN SASH



OUTWARD

ADDITIONAL OPTIONS
OF WINDOW SYSTEM

INDUSTRIAL

- Modern solutions that imitate the shape of steel windows
- Fully matching following systems TM 62 & TM 77
- Possibility of creating modern window structures in various arrangements

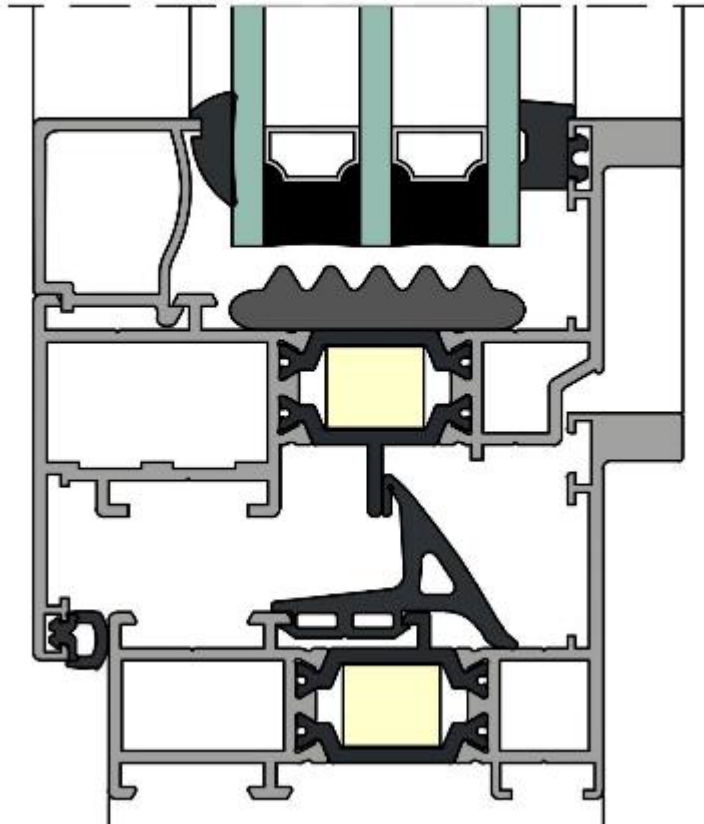

INDUSTRIAL

SDL BARS



Available in each system

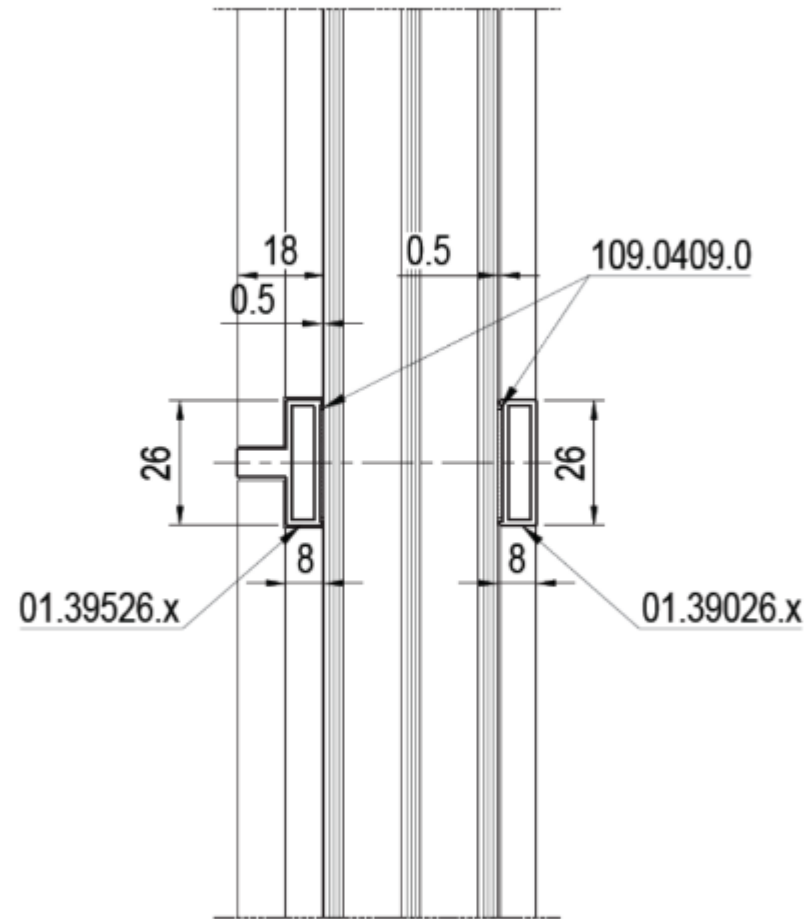

SDL bars are glued to the glass

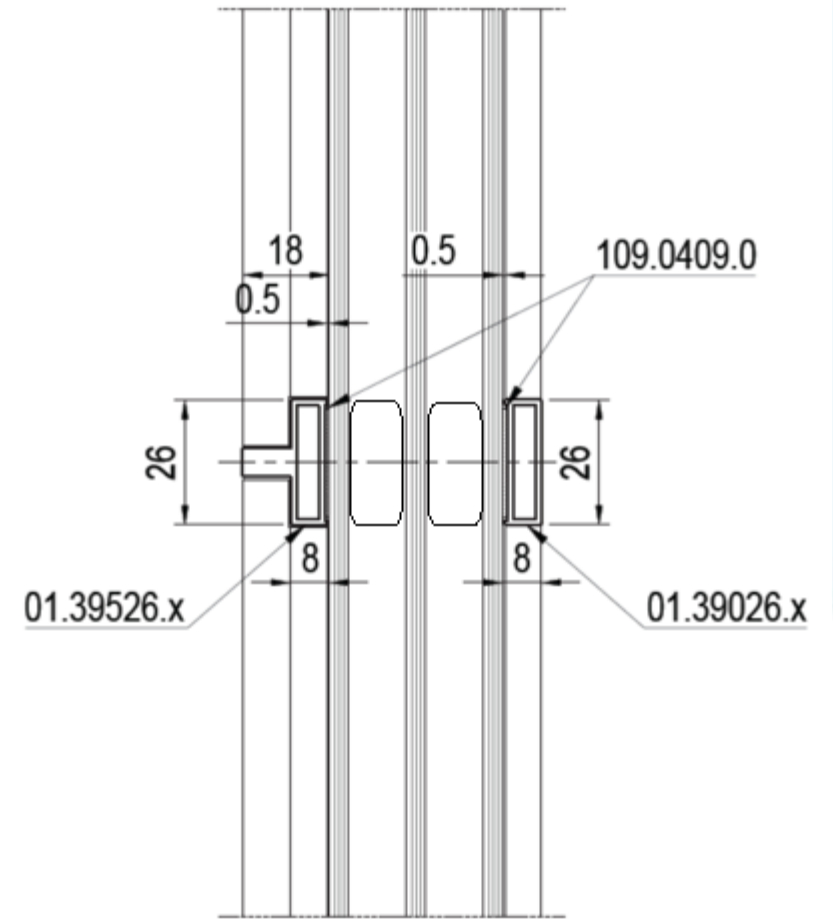

SDL bars are glued to the glass and also between each glass pane

INDUSTRIAL CONFIGURATION OPTIONS

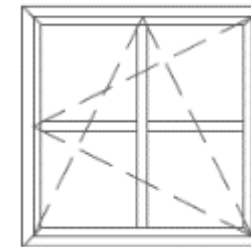
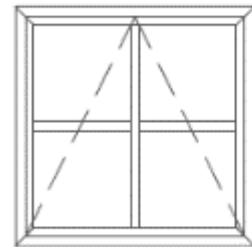
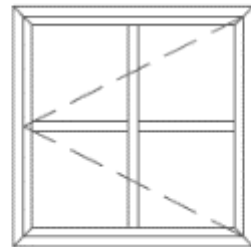
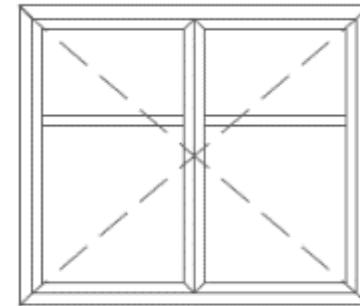
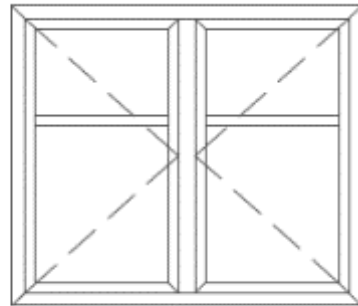
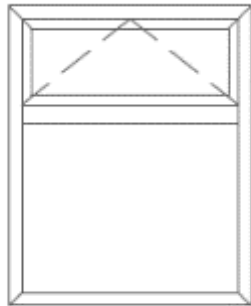
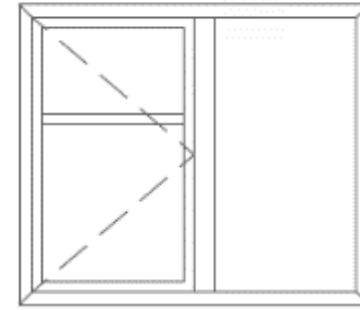
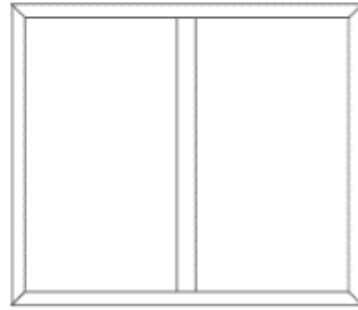
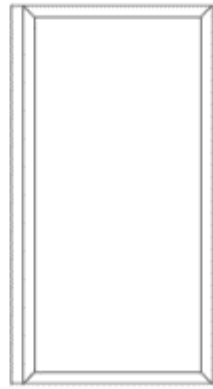



HIDDEN SASH

Only for TM62 & TM77

- Solution that makes the window sash invisible
- Contemporary minimalistic look with maximum light
- An option of combining/mulling with other Yawal systems.

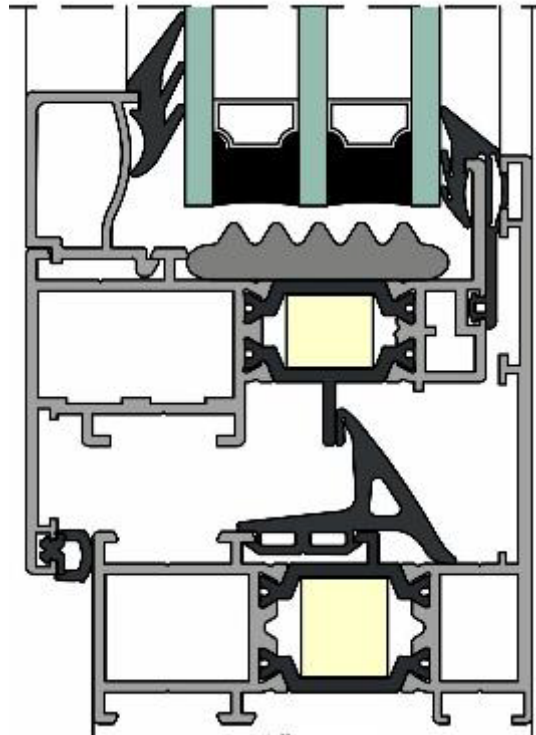

CONSEALED SASH CONFIGURATION

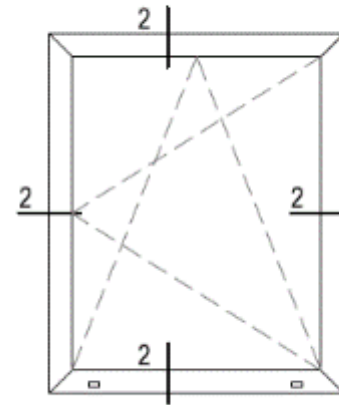
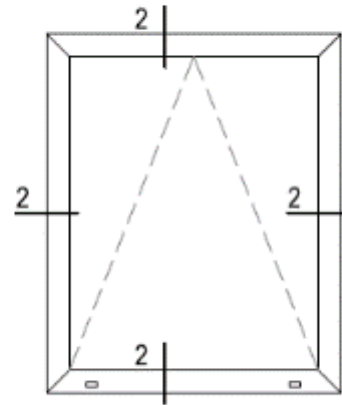
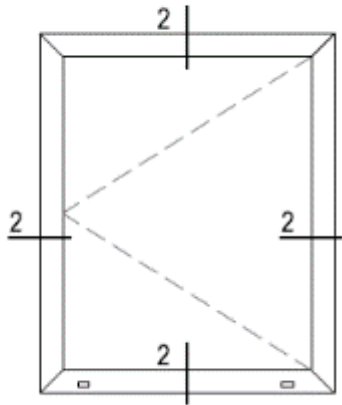
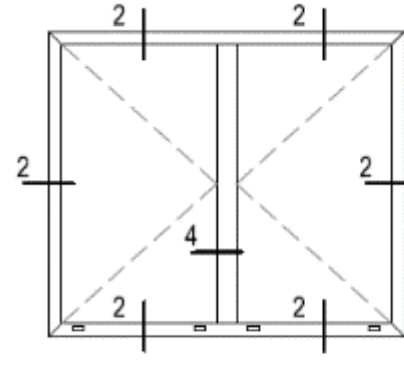
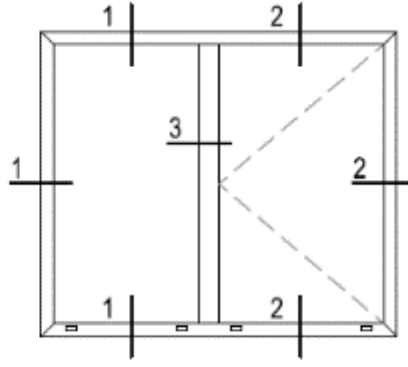
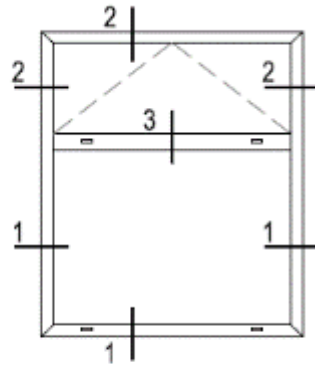



YAWAL
ALUMINIUM + ARCHITEKTURA



OUTSWING

Only for TM62 & TM77

- Solution for outswing window
- Space-saving inside the room
- Perfect tightness of the structure
- Possibility of implementing modern window structures in various arrangement

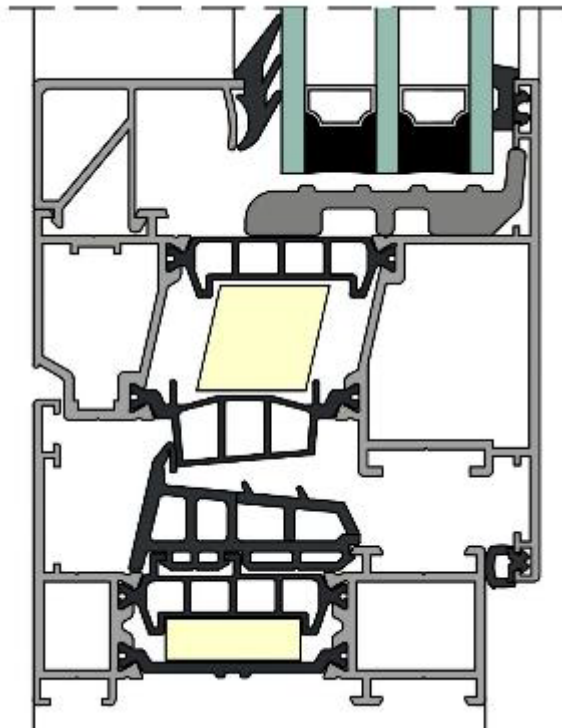

Click to add text



OUTSWING OPENING OPTIONS

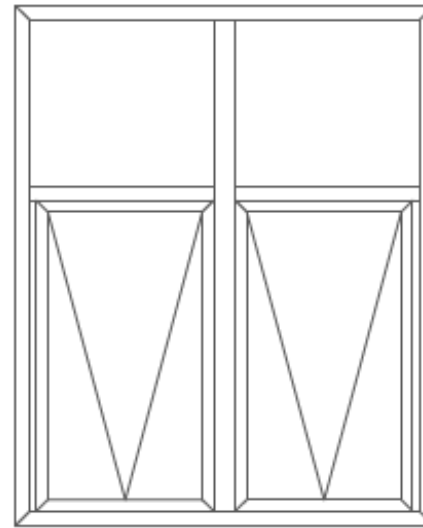
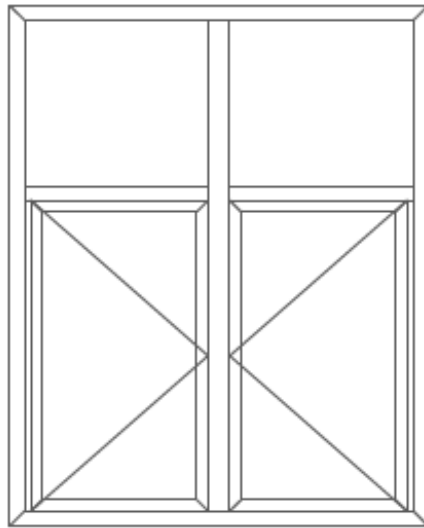
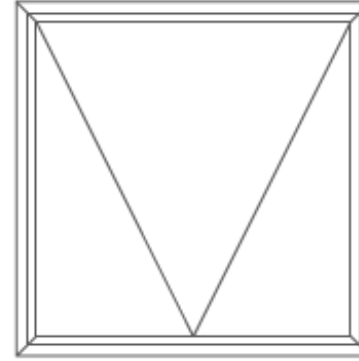
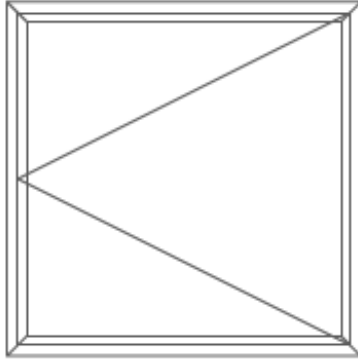



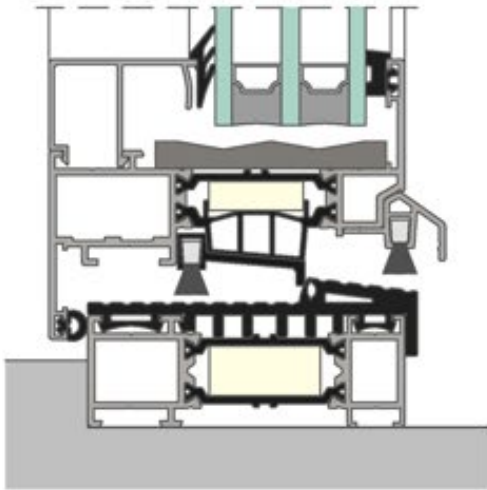

**LOW
THRESHOLD**



**INSECT
SCREENS**



**PRIVA LITE
GLASS**



**JULIET
BALCONIES**

OPTIONAL EQUIPMENT

OPTIONAL EQUIPMENT

LOW THRESHOLD

Possibility of making balcony door
with low threshold

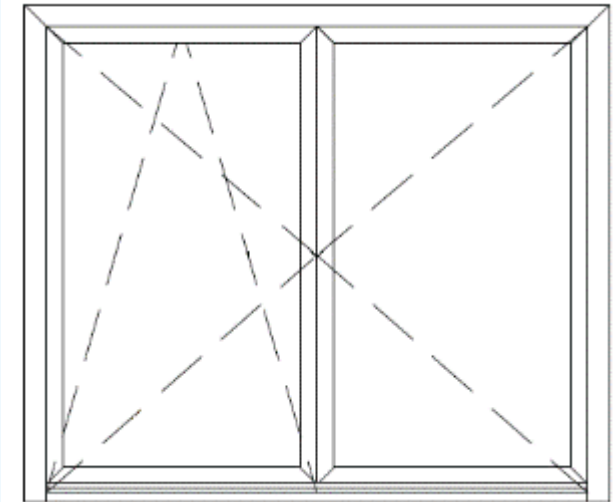
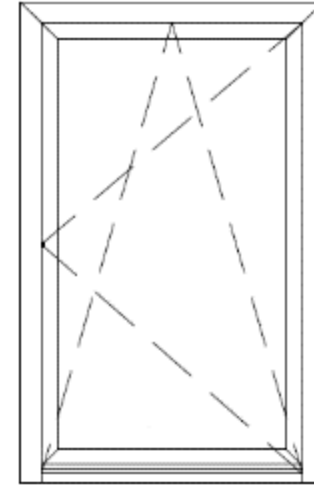
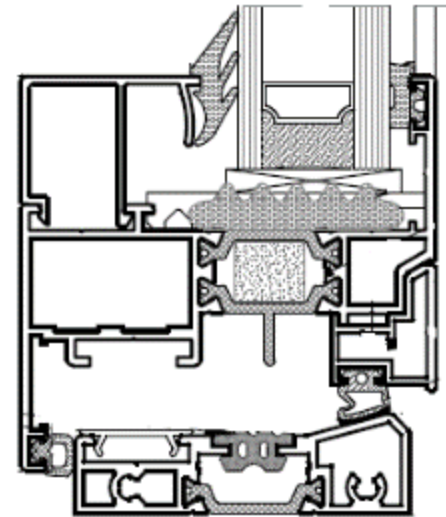
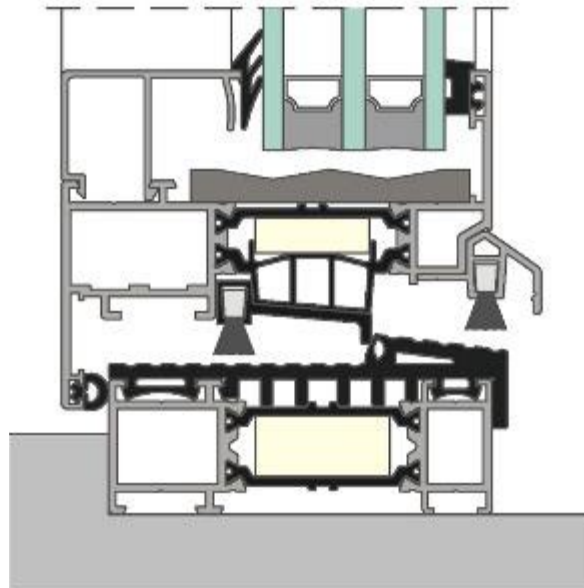
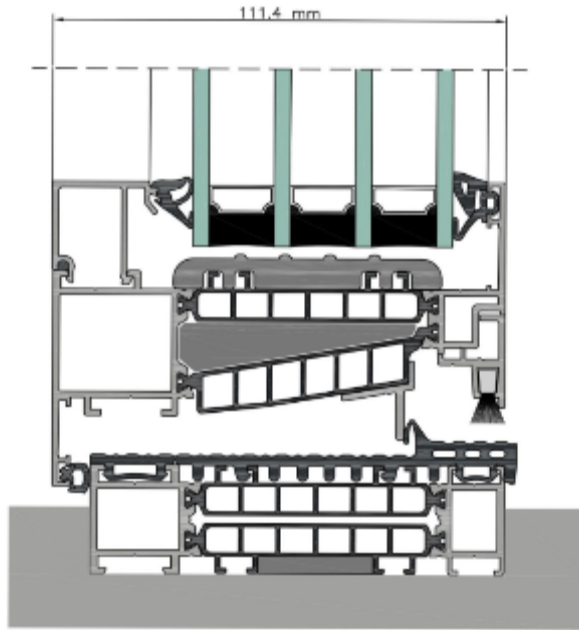

OPTIONAL EQUIPMENT

INSECT SCREENS

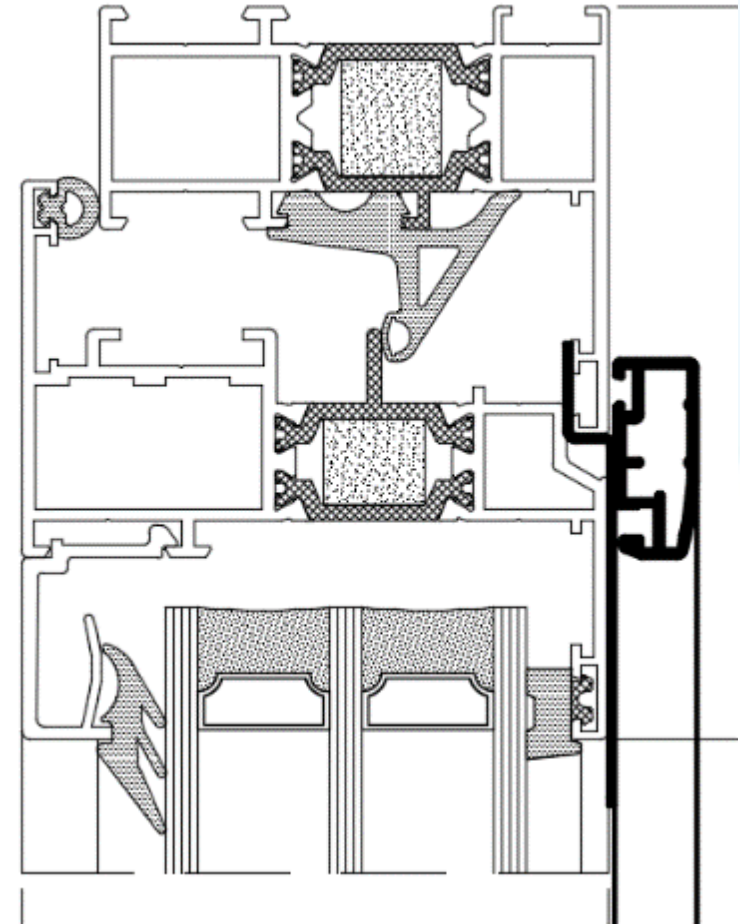

OPTIONAL EQUIPMENT

PRIVE LITE GLASS

APPLICATIONS

Everywhere you want to obtain the "WOW" effect: exhibition systems, stands, meetings rooms, display windows, facades.



APPLICATIONS

Mainly in conservatories and swimming pools due to comfort assured by EGALS and privacy of PRIVA-LITE



OPTIONAL EQUIPMENT

JULIET BALCONIES

- Installation to the frame
- Masking clip of the fixing screws
- Aluminium strip securing the window edge
- Increases acoustic insulation of the building

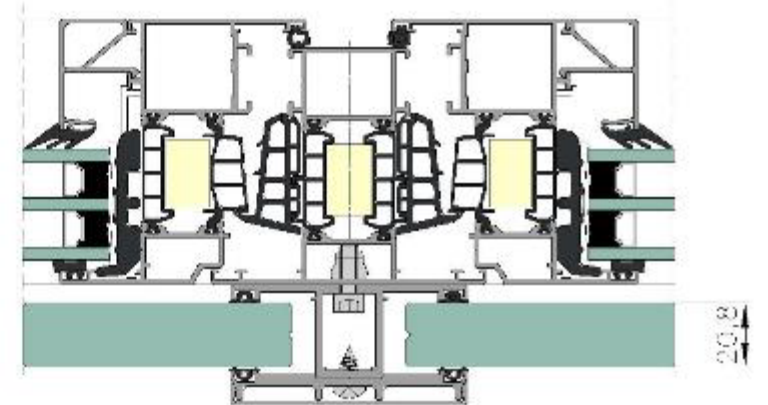
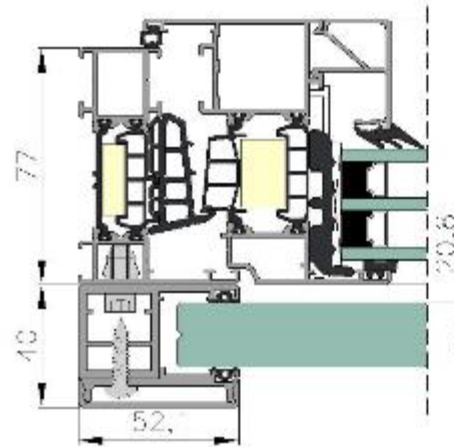





GLASS



PRESTIGE

DOOR SYSTEM

GLASS DOOR SYSTEMS



- This door can go “oversize” with a maximum height of 12 ft and width of 5 ft
- Easily integrates with the other products in the same product line
- Same slim profile on styles and rails or with a kick profile on the bottom



Strap installation example

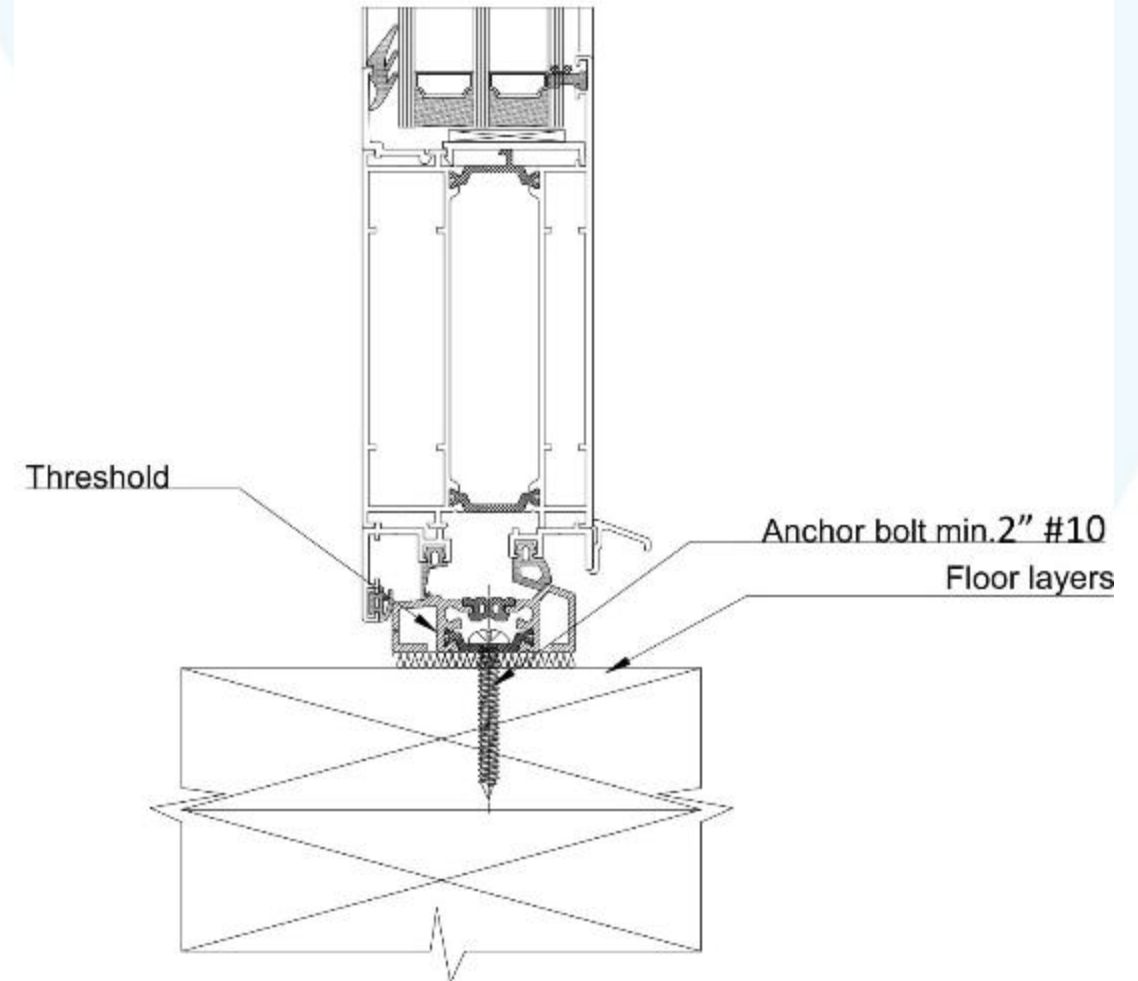
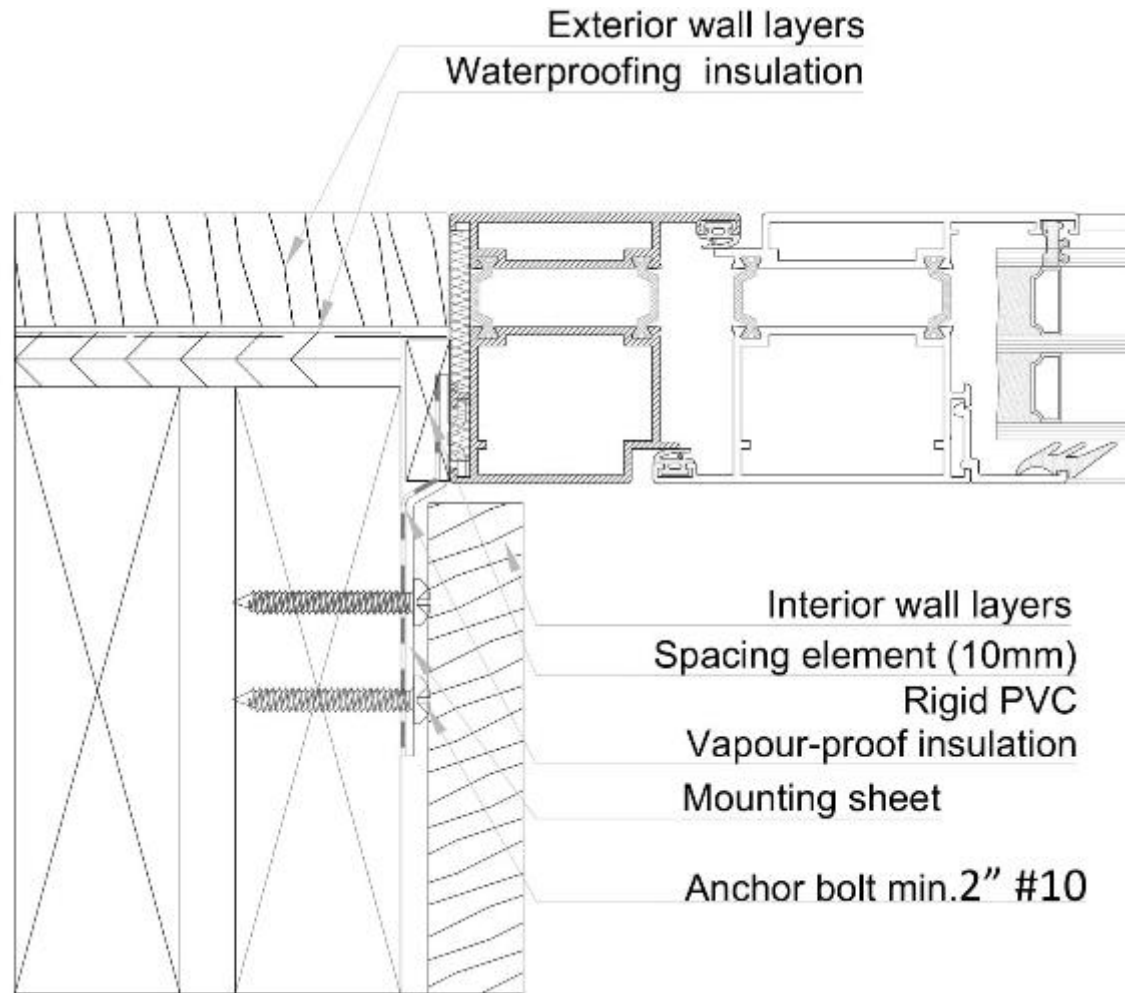

Through frame installation example

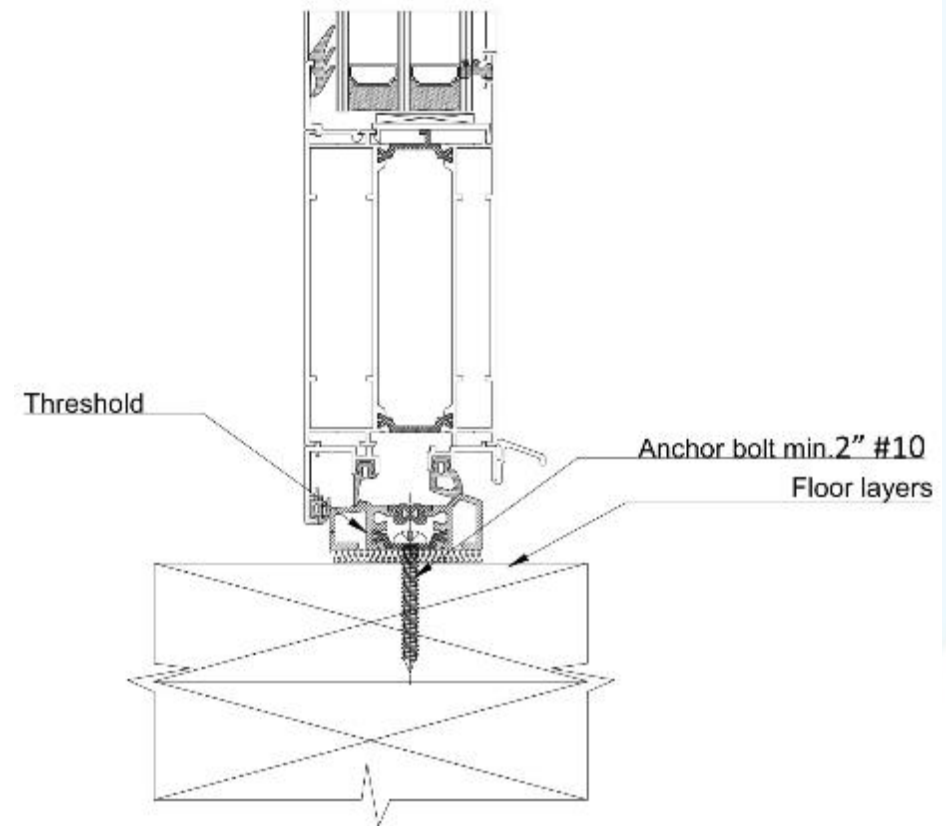
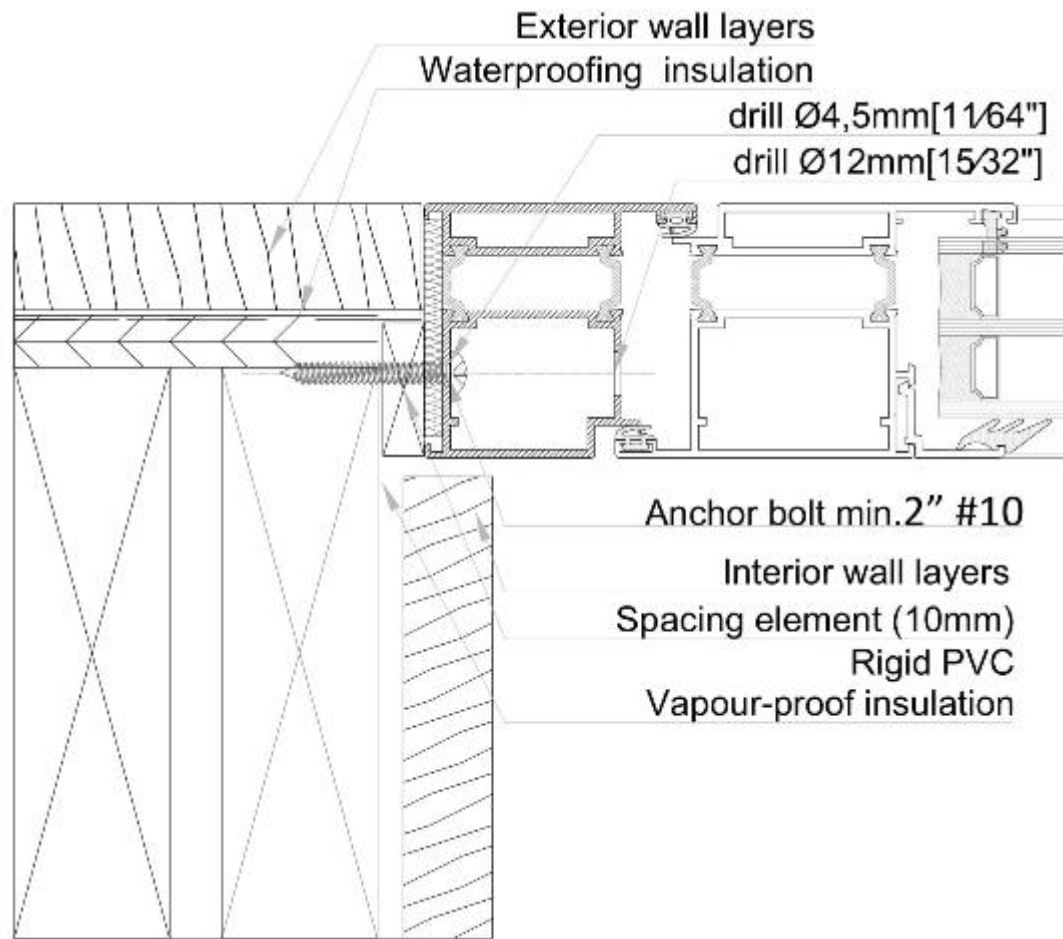

CONFIGURATION POSSIBILITIES

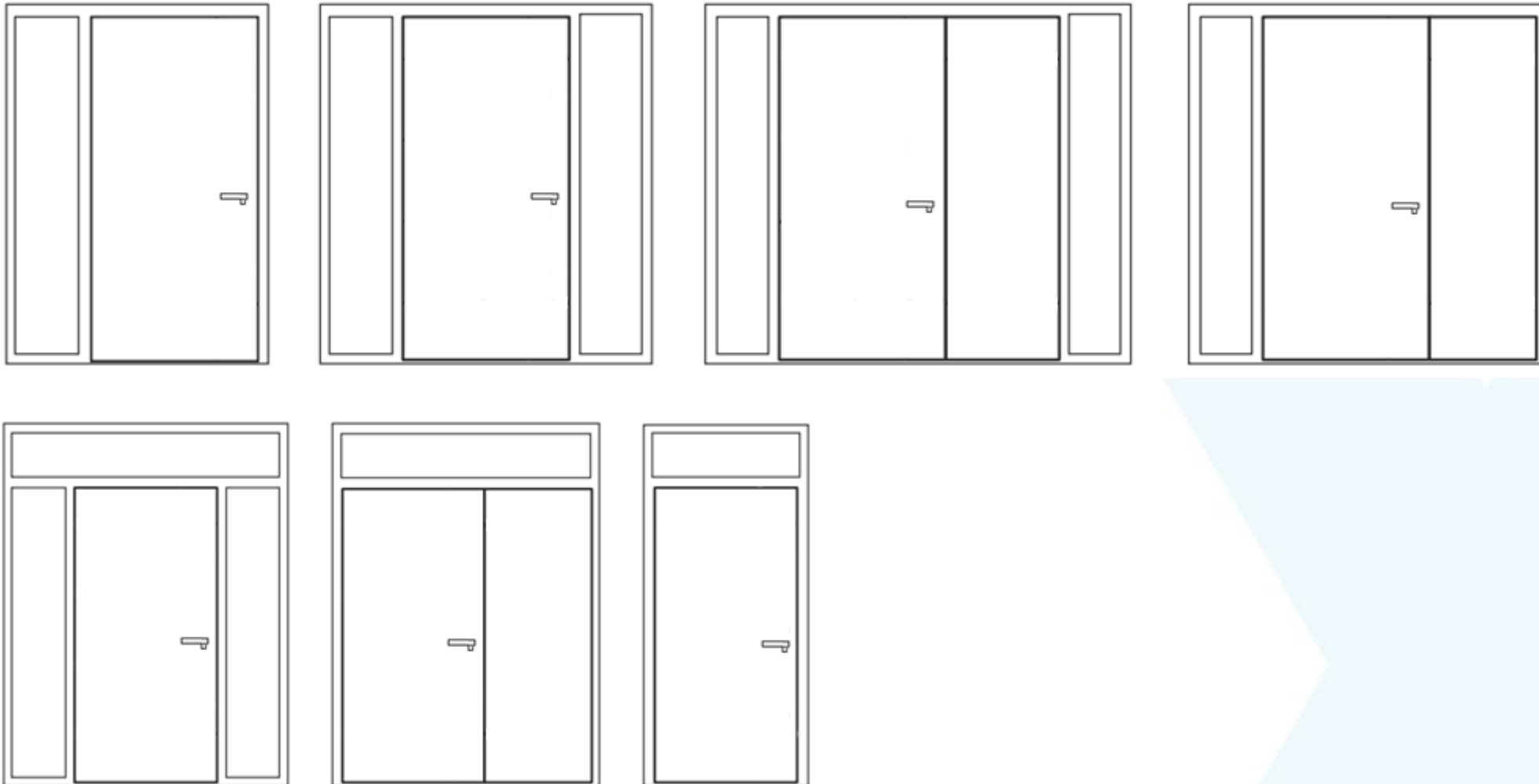

STANDARD HARDWARE

visible hinges
Matching
Color



handle from both sides
Stainless steel



Keyed cylinder
with thumb-turn



three-point lock



PRESTIGE DOOR



TM 102 PRESTIGE

TM 77 PRESTIGE



- It's a state-of-the-art entry door system
- Superior quality entry door systems for houses or apartment buildings
- Excellent aesthetics of the system due to hidden hinges
- Durable color, easy to clean
- Maximum width of 4 ft 5in and height of 10 ft
- Easily integrates with the other products in the same product line

CONFIGURATION POSSIBILITIES

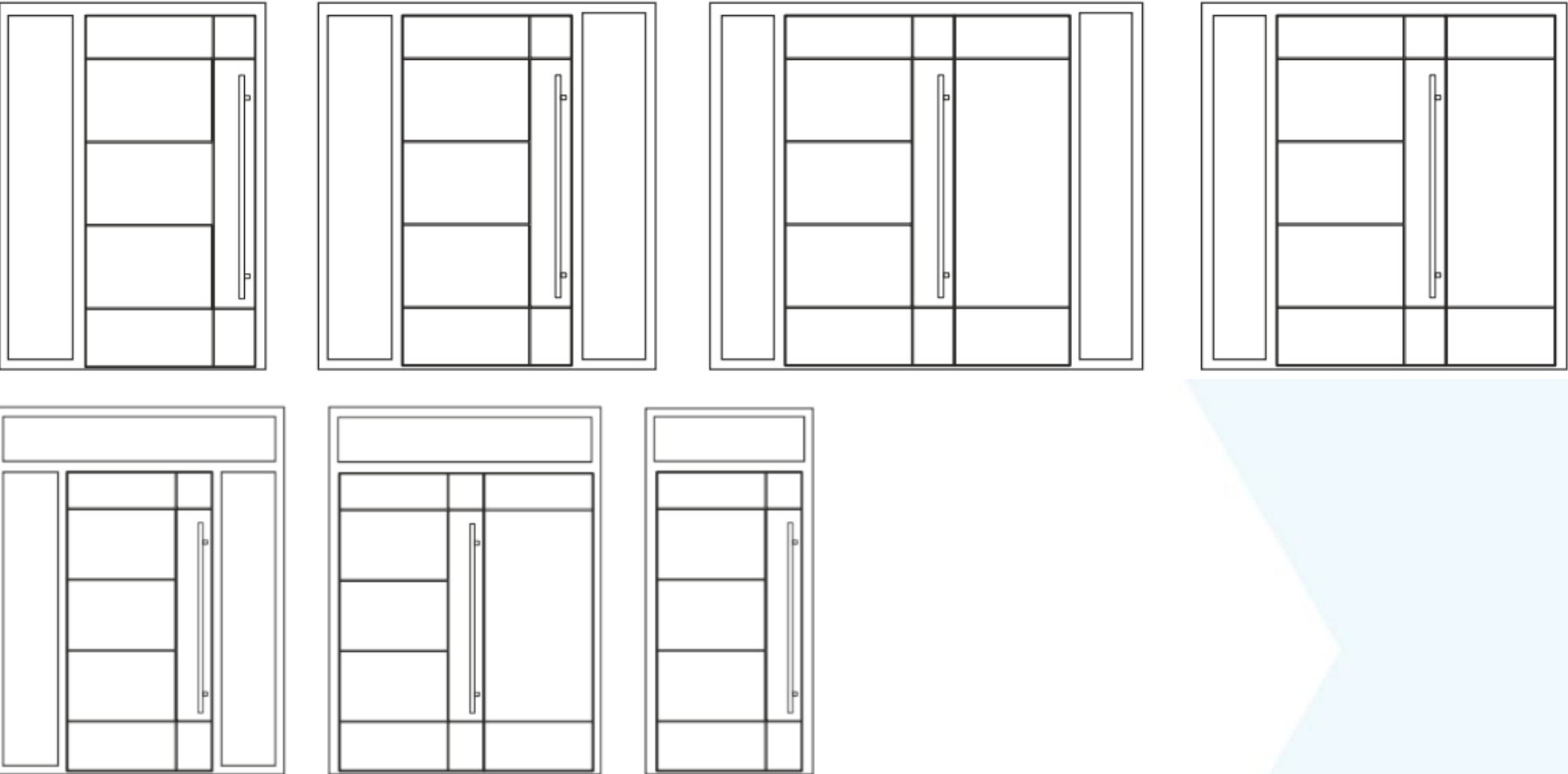

Through frame installation example

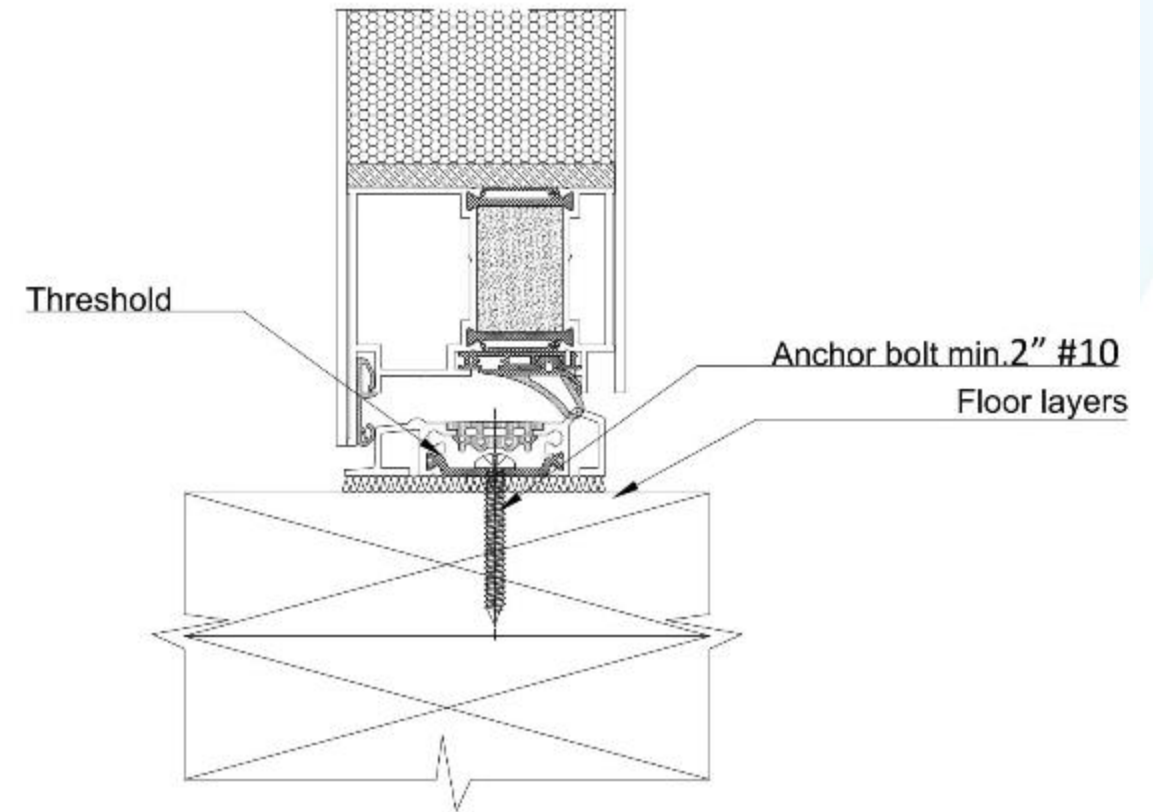
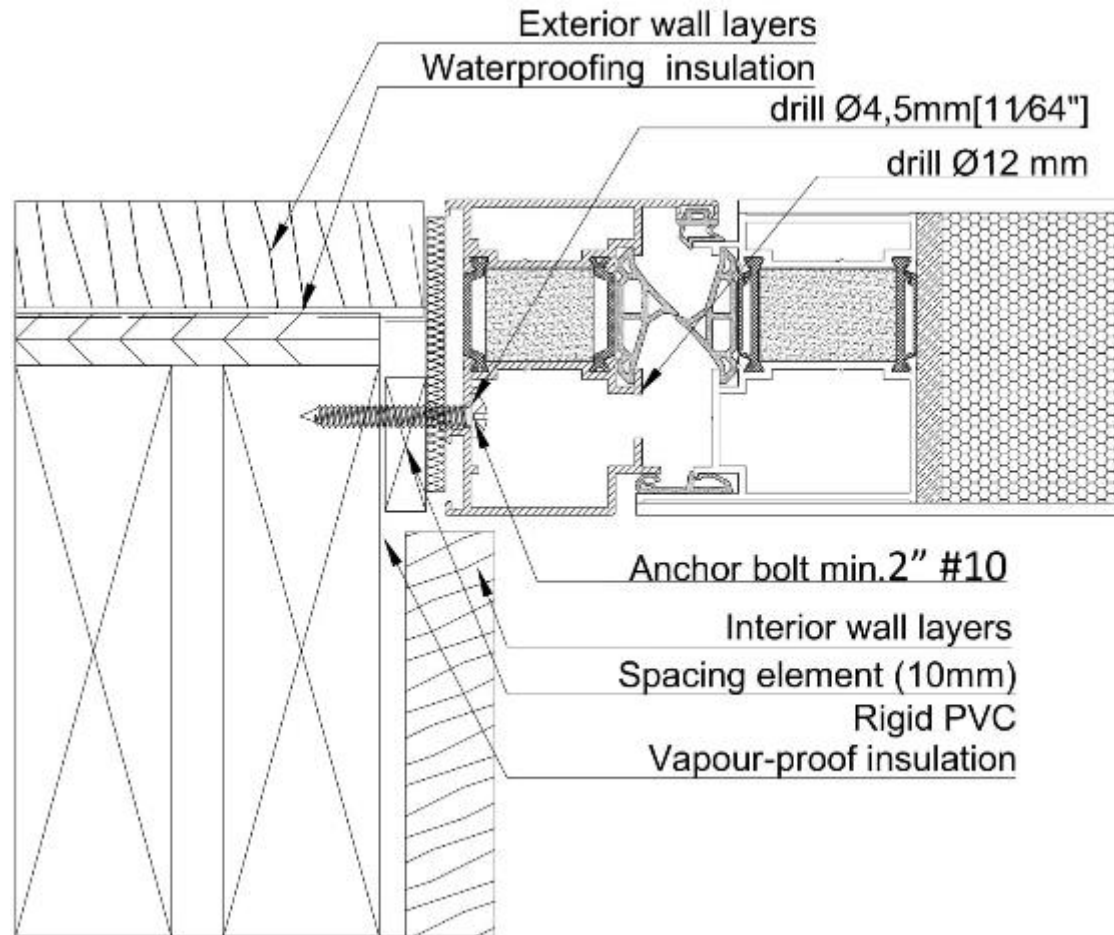

Strap installation example

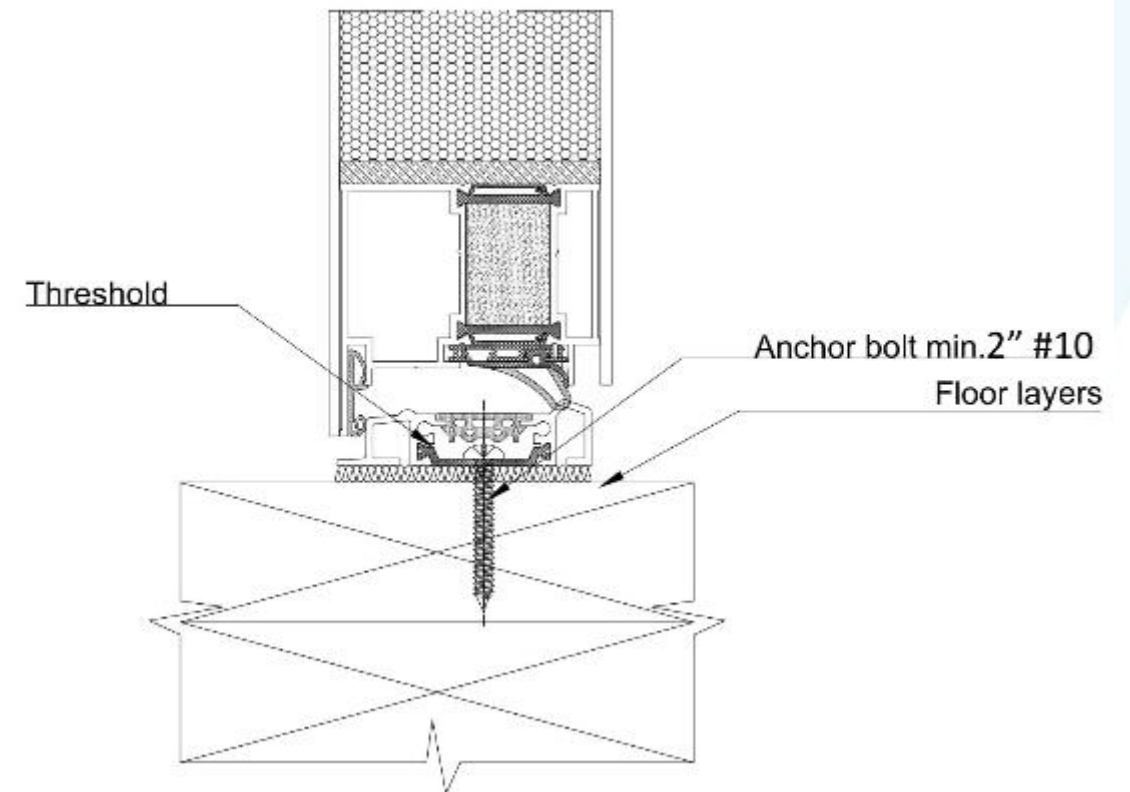
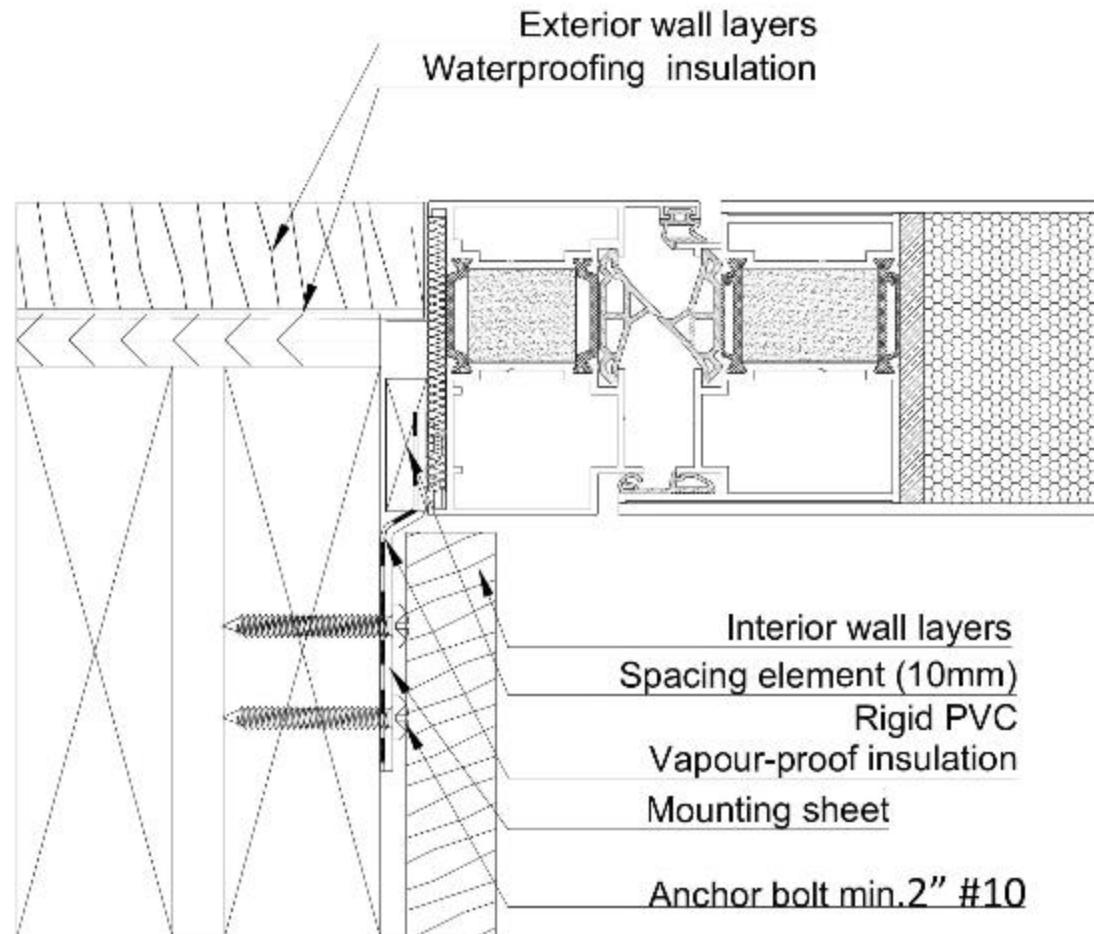

STANDARD HARDWARE

hidden hinges



handle from both sides
Stainless steel



Keyed cylinder
with thumb-turn



three-point lock



ADDITIONAL HANDLES OPTIONS

Pull handles



ADDITIONAL LEVER OPTIONS

Handles



ADDITIONAL OPTIONS

Locks



Motorized three-point lock

Biometric handle with EKEY fingerprint reader



Handle with a touch sensor

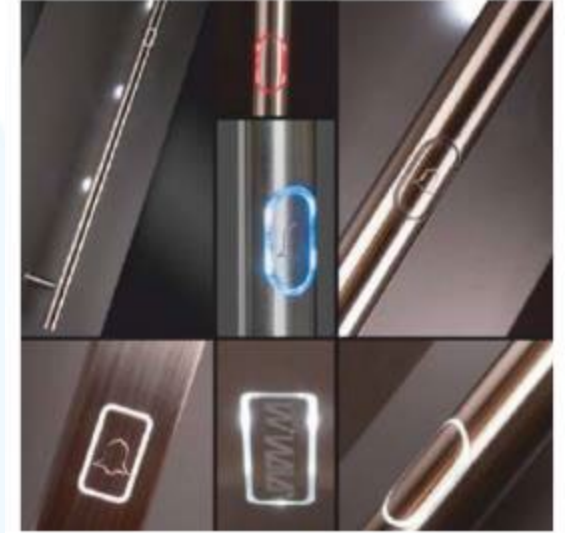

Biometric or key pad to be installed on doors



AVAILABLE PANELS OPTIONS



AVAILABLE PANELS

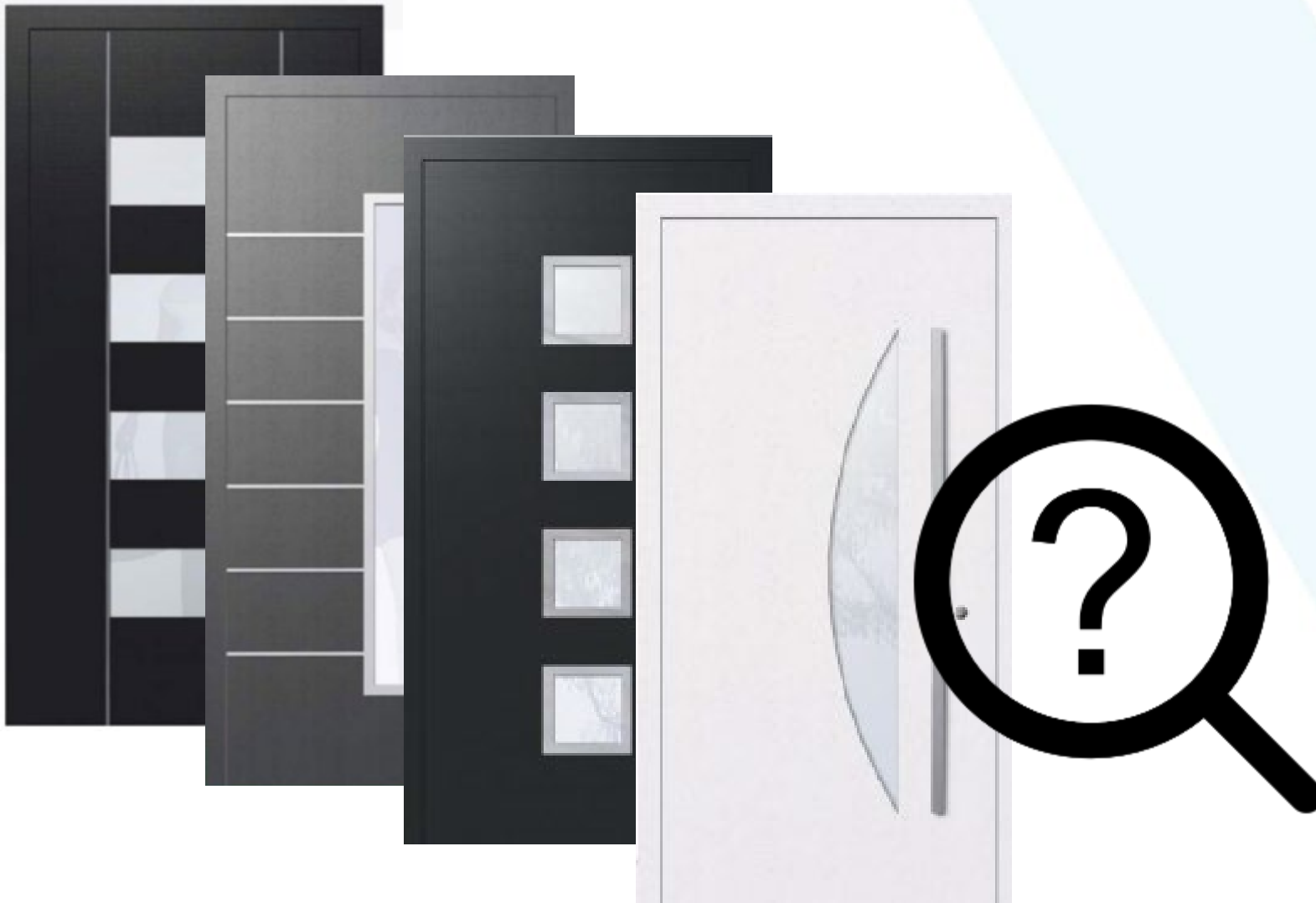

**Other patterns
available for request**

PRIMEVIEW OPTION

Primeview Full glass

PRESTIGE doors



OPTIONAL EQUIPMENT

LED PROFILE

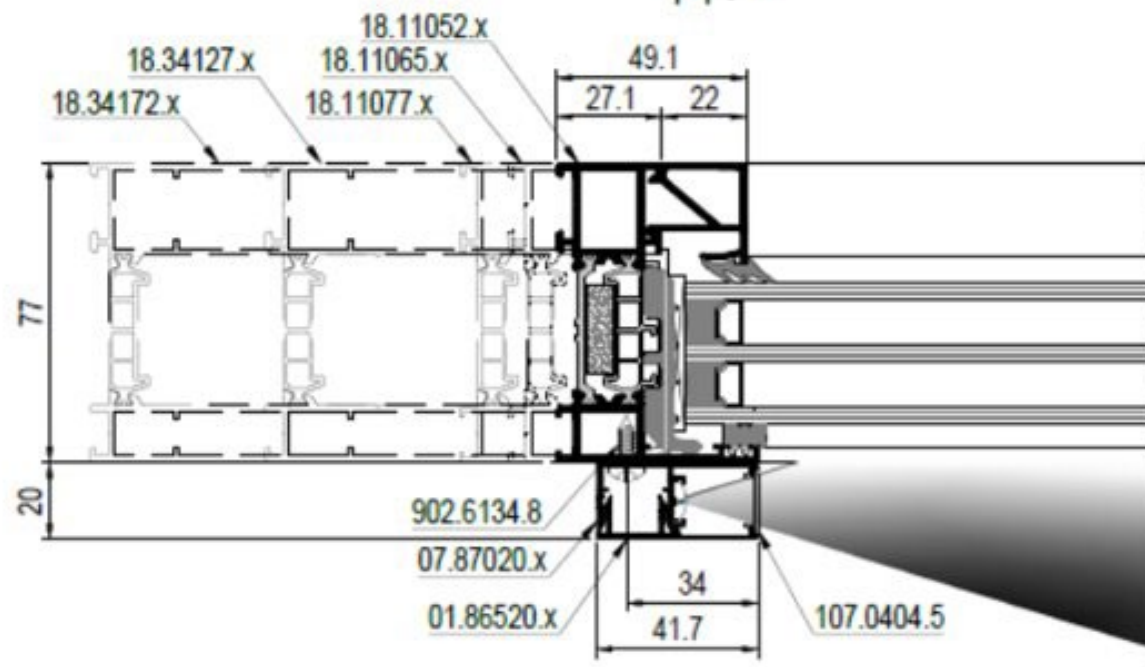
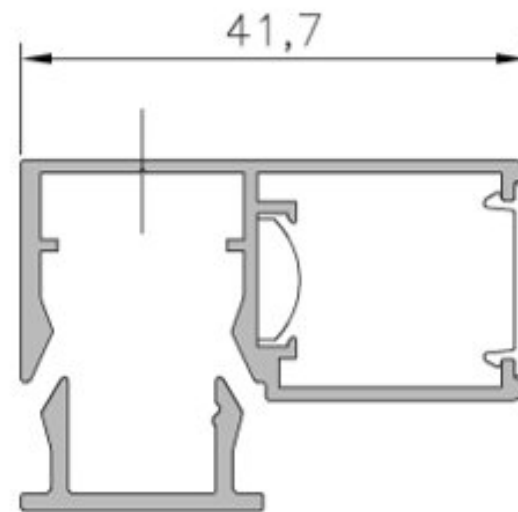
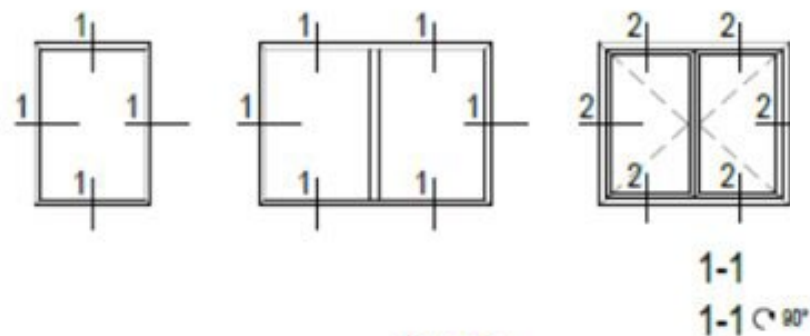

THANK YOU

Contact Us

Yawal dealer:

Laurel Windows

156 S Broad St

Brevard, NC 28712, USA

T. 828-866-3170

o info@laurelwindows.us



www.yawalusa.com